

VITRIS 120 Soft close sliding system

Wall Mounted

EVW2SD 2m track, for single door

EVW4SD 4m track, for single door

EVW4DD 4m track, for double door

Ceiling Mounted

EVC2SD 2m track, for single door

EVC4SD 4m track, for single door

EVC4DD 4m track, for double door

Glass Mounted

EVCG1SD single door - threshold opening 1m

EVG12SD single door - threshold opening 1.2m

AVAILABLE FINISHES

- Satin anodised aluminium
- Selected powdercoat, lead time applies

TECHNICAL DETAILS

Each pack includes:

1 x soft close mechanism, track, end caps and cover,
wheel assemblies, door stops and floor guide

Suitable for 8mm, 10mm and 12mm toughened glass or
8.76mm, 10.76mm and 12.76mm toughened laminated glass

Max load 120kg per door without soft close action

Max load 80kg per door with soft close action

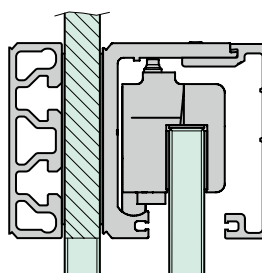
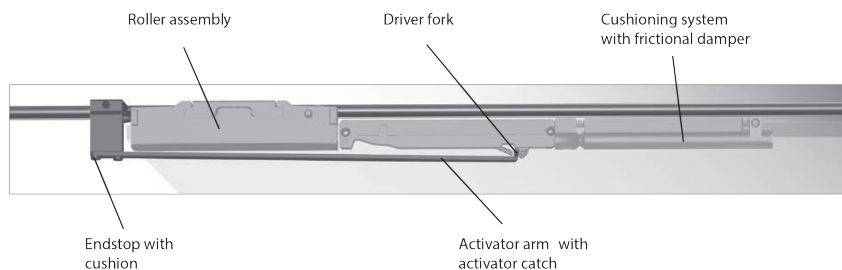

Glass mounted

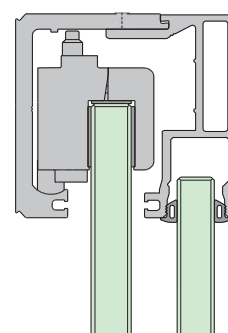

Ceiling mounted
with side panel
coverplate

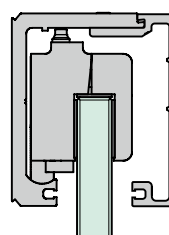

Wall and Ceiling
mounted



VITRIS 120 Soft close sliding system

GLASS DETAIL

Wall Mounted

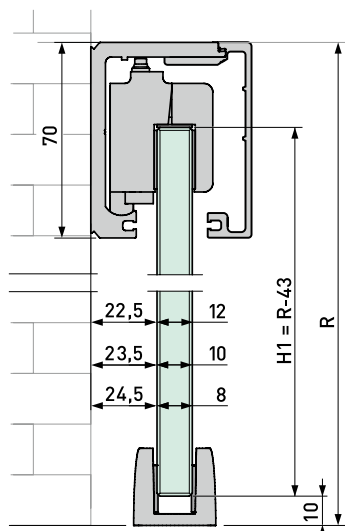

Determination of glass height:
 $H = R - 43\text{mm}$

Determination of glass width:
 $A = LW + 70\text{mm}$ (single door)
 $A = LW/2 + 33\text{mm}$ (double door)

Key

A	= glass width of sliding sash
B	= glass width of fixed sash
BO	= transom light width
C	= track length
H1	= glass height of sliding sash
H2	= glass height of fixed sash
LH	= clear height
LW	= clear width (opening)
LW_t	= clear width of door opening
R	= room height

Ceiling Mounted

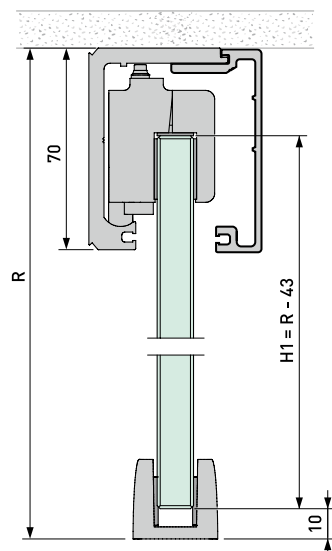

Determination of glass height:
 $H = R - 43\text{mm}$

Determination of glass width:
 $A = LW + 70\text{mm}$ (single door)
 $A = LW/2 + 33\text{mm}$ (double door)

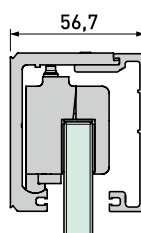

VITRIS 120 Soft close sliding system

Track mounted to wall

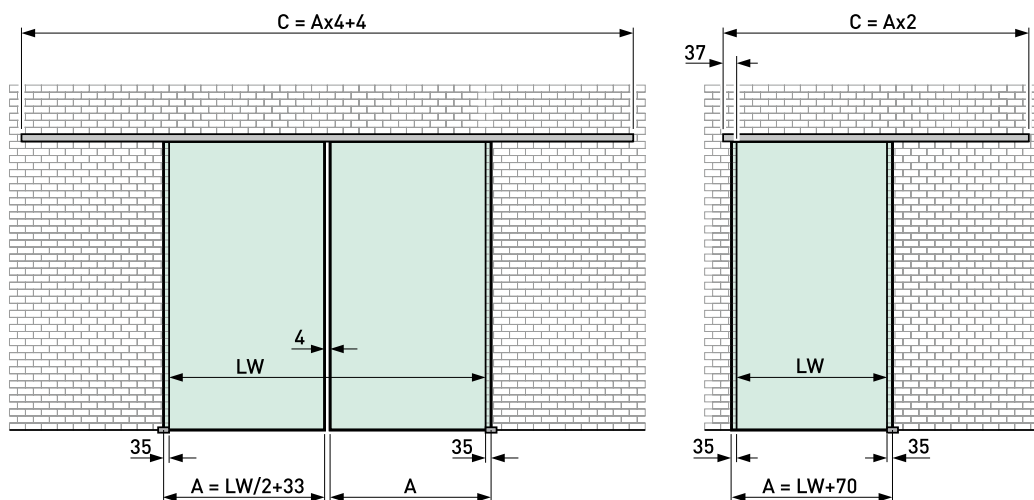

Track mounted to ceiling

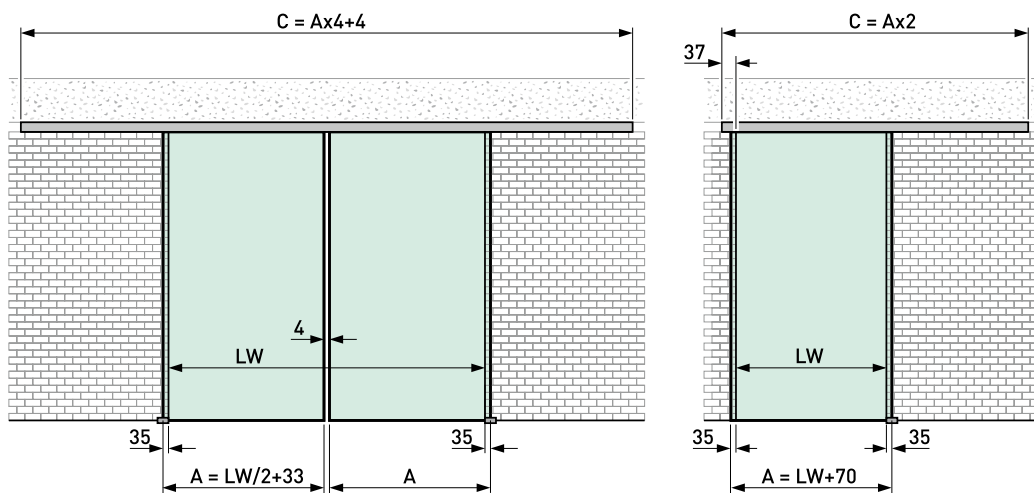

Key

A	= glass width of sliding sash
B	= glass width of fixed sash
BO	= transom light width
C	= track length
H1	= glass height of sliding sash
H2	= glass height of fixed sash
LH	= clear height
LW	= clear width (opening)
LW_i	= clear width of door opening
R	= room height

VITRIS 120 Soft close sliding system

Ceiling mounted with side panel coverplate

Glass calculations used on these drawings do not take into account any clearances or gaps for wall or floor glazing channels. Glazing channel clearances or glass gaps will need to be deducted in accordance with the type of glazing channel used. CU25 is compatible with this system (sold separately).

Key

A	= glass width of sliding sash
B	= glass width of fixed sash
BO	= transom light width
C	= track length
H1	= glass height of sliding sash
H2	= glass height of fixed sash
LH	= clear height
LW	= clear width (opening)
LW_c	= clear width of door opening
R	= room height

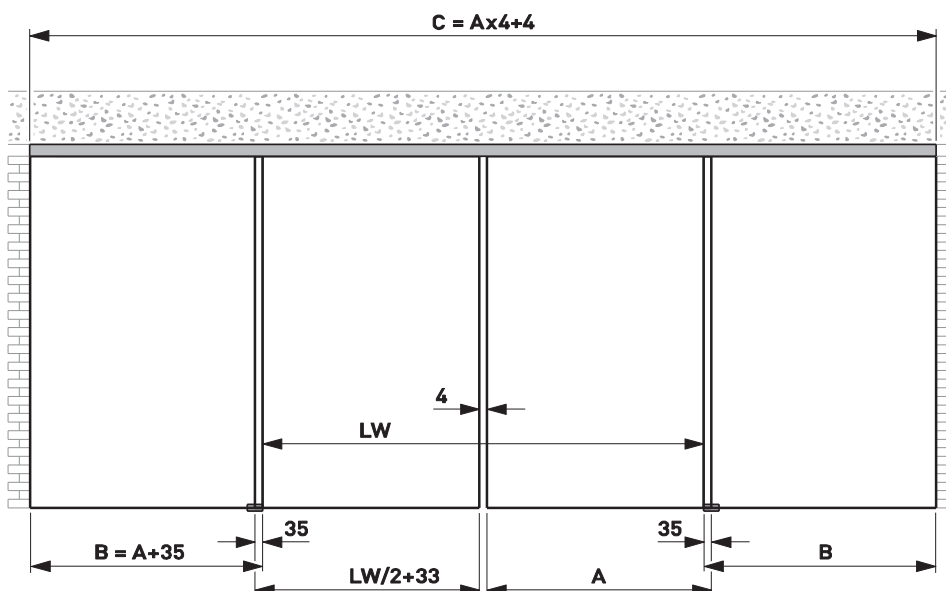
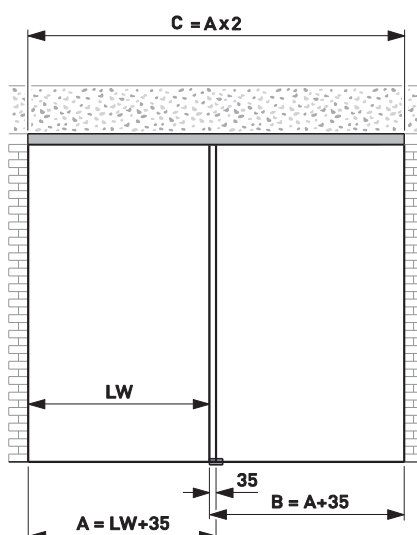
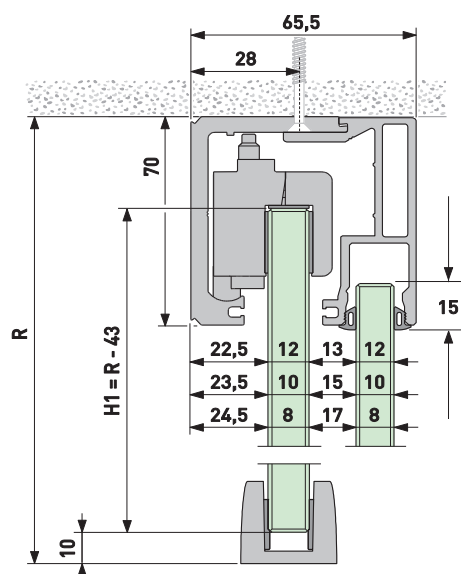

SLIDING DOOR SYSTEMS: VITRIS 120 SOFT CLOSE

CALL: (09) 624-1180
www.euroglass.co.nz

euroglass™

VITRIS 120 Soft close sliding system

GLASS DETAIL

Glass Mounted

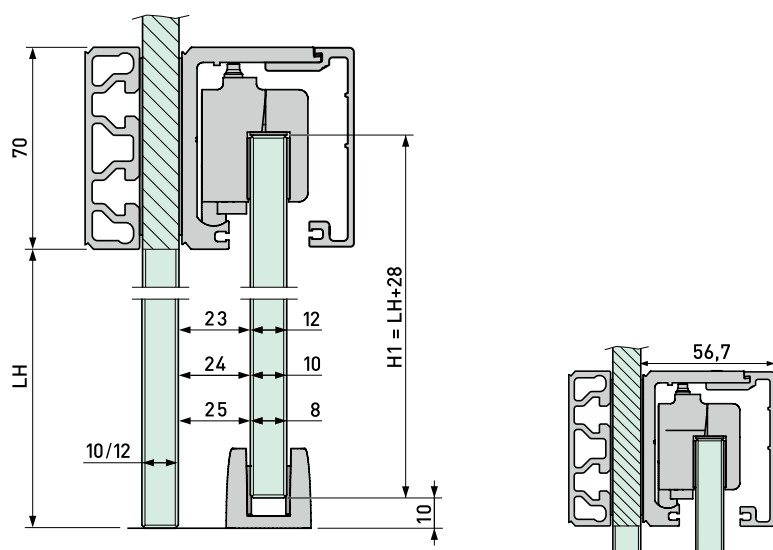

Key

A	= glass width of sliding sash
B	= glass width of fixed sash
BO	= transom light width
C	= track length
H1	= glass height of sliding sash
H2	= glass height of fixed sash
LH	= clear height
LW	= clear width (opening)
LW _t	= clear width of door opening
R	= room height

Track mounted to glass facade

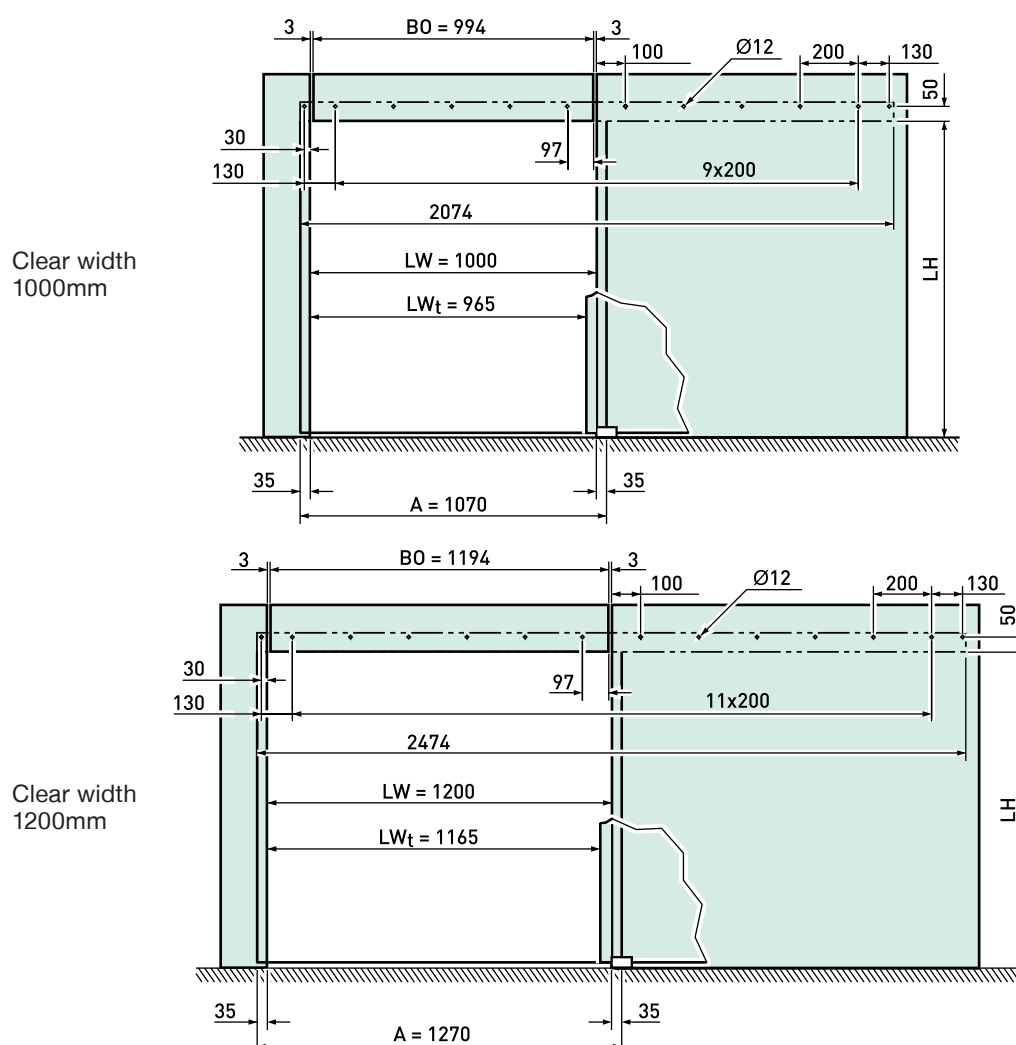

RG40 Tenza Ultra Span Sliding Door System

AVAILABLE FINISHES

Satin anodised aluminium

APPLICATIONS

Shower enclosures
Interior home and office doors

TECHNICAL DETAILS

Sliding door track is mounted between two walls
Track is unsupported, ceiling fixings are not required
Max span of 2 meters from wall to wall
Max door weight = 40kgs
Side panels are easily glazed into the top track and floor channel
Floor guide and floor stop is inserted into the side panel floor channel, screwing through the floor is not required

Supplied as a complete set. Each TENZA track pack contains;
2m track, 2m track cover, 2m floor channel, 2m top track infill, 2x wheel assemblies, 2x top track door stops, 1x floor channel door guide, 1x floor channel door stop, 3x 2m clip on door bump seals and 2x track wall mounting brackets

Euroglass offer a specialist Tenza which spans up to 3 meters (lead time applies)

COMMON CONFIGURATIONS;

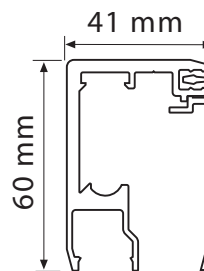

Side panel with door
(standard TENZA track pack)

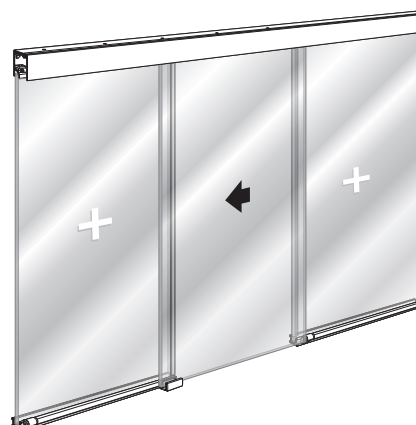

Double side panel with door
(additional bottom track stop required)

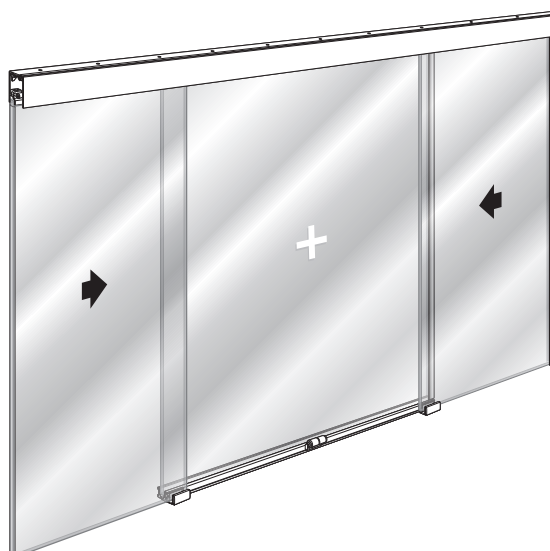

Centre panel with double door
(additional fittings required)

RG40 Tenza Ultra Span Sliding Door System

GLASS DETAILS

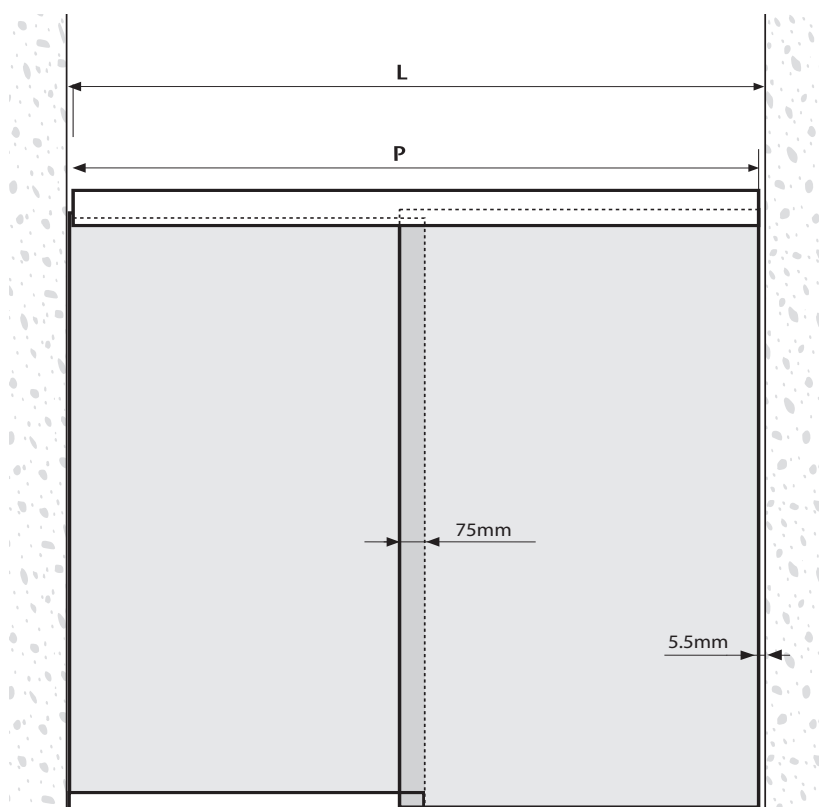
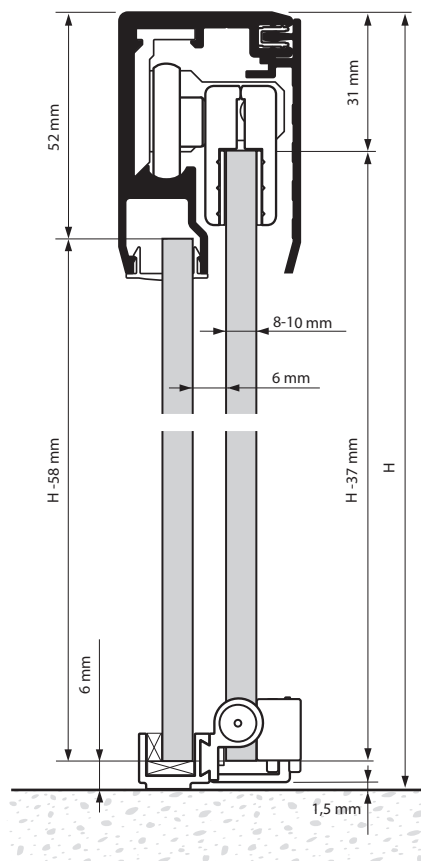

$P = L - 5 \text{ mm (max 2m)}$

SS30 Verona sliding shower kits

AVAILABLE FINISHES

- Satin stainless steel

TECHNICAL DETAILS

Manufactured in stainless steel
Designed for 10mm toughened glass
Suitable for both inline and square showers
Able to be fixed to glass or solid walls
Maximum hanger load 45kg per door
Rail is a rectangular hollow section
Rail height 50mm, thickness 10mm

Custom kits available upon request

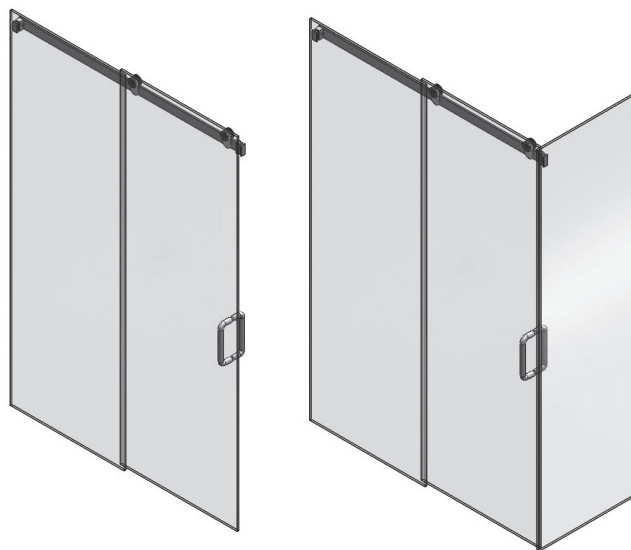

STANDARD SHOWER CONFIGURATIONS

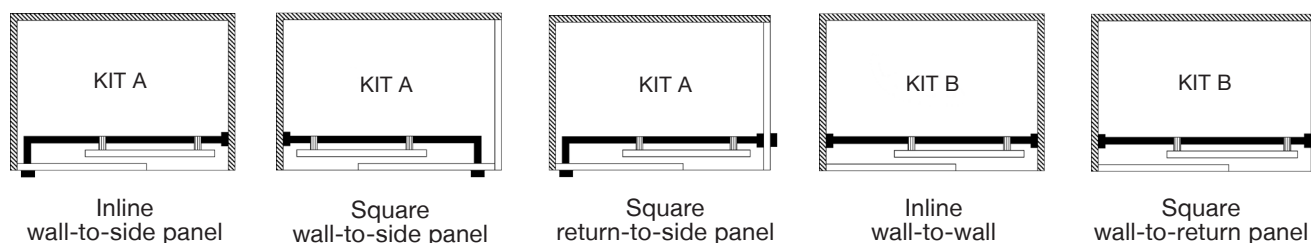

KIT A or B supplied based on the shower configurations above

KIT A	KIT B
Door opening 600mm	Specify tight opening size on ordering
Rail length 1350mm	Max opening width 1400mm
1 x Rail	1 x Rail
1 x Glass/Wall Mount	2 x Glass/Wall Mounts
1 x Side Panel Mount/Stop	2 x Hangers
2 x Hangers	1 x Adjustable Stop
1 x Rail End Plug	1 x Door Seals (3m)
1 x Door Seal (3m)	1 x Floor Guide
1 x Floor Guide	



SS30H
Hanger

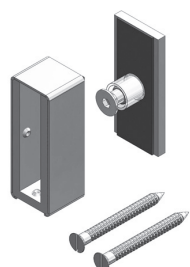

SS30WM
Glass/Wall Mount

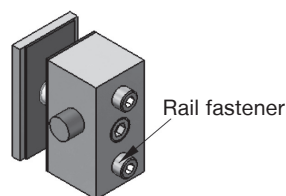

SS30SM
Side Panel Mount/Stop

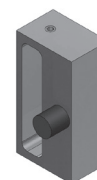

SS30AS
Adjustable Stop



SS30RAIL
Rail

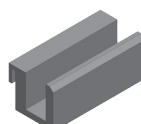

SSG10
Floor Guide

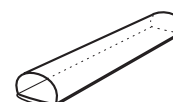

DS4
Door Seal (3m length)

SS30 Verona sliding shower kits

GLASS CUTOUT DETAIL: KIT A

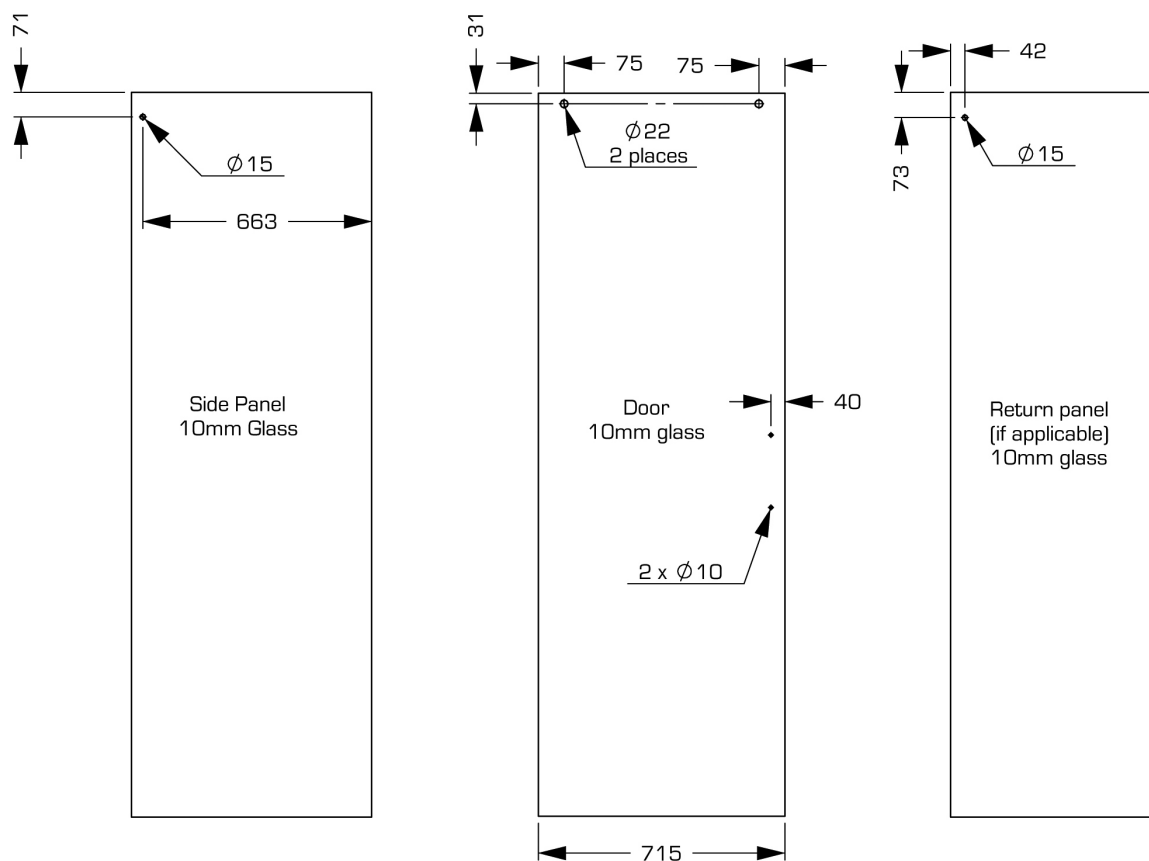
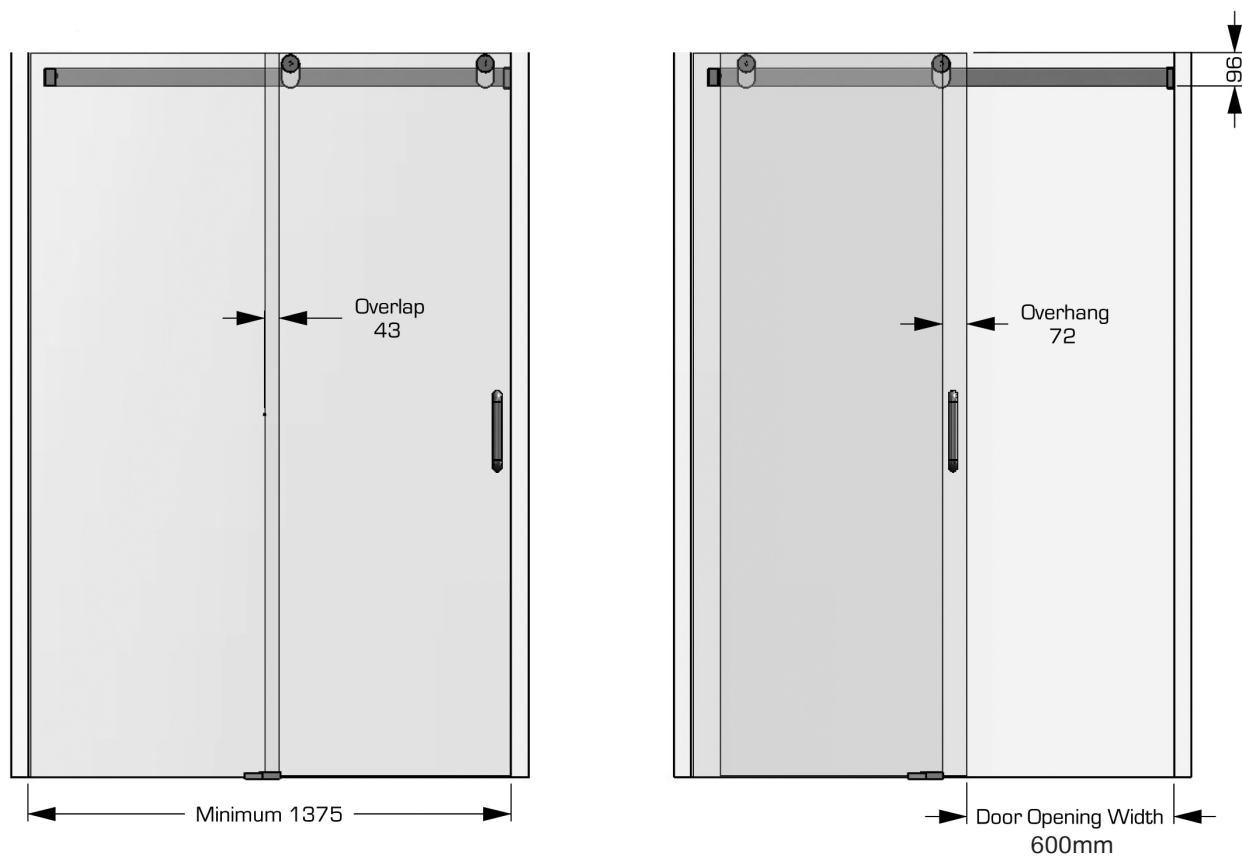

SS30 Verona sliding shower kits
GLASS CUTOUT DETAIL: KIT B

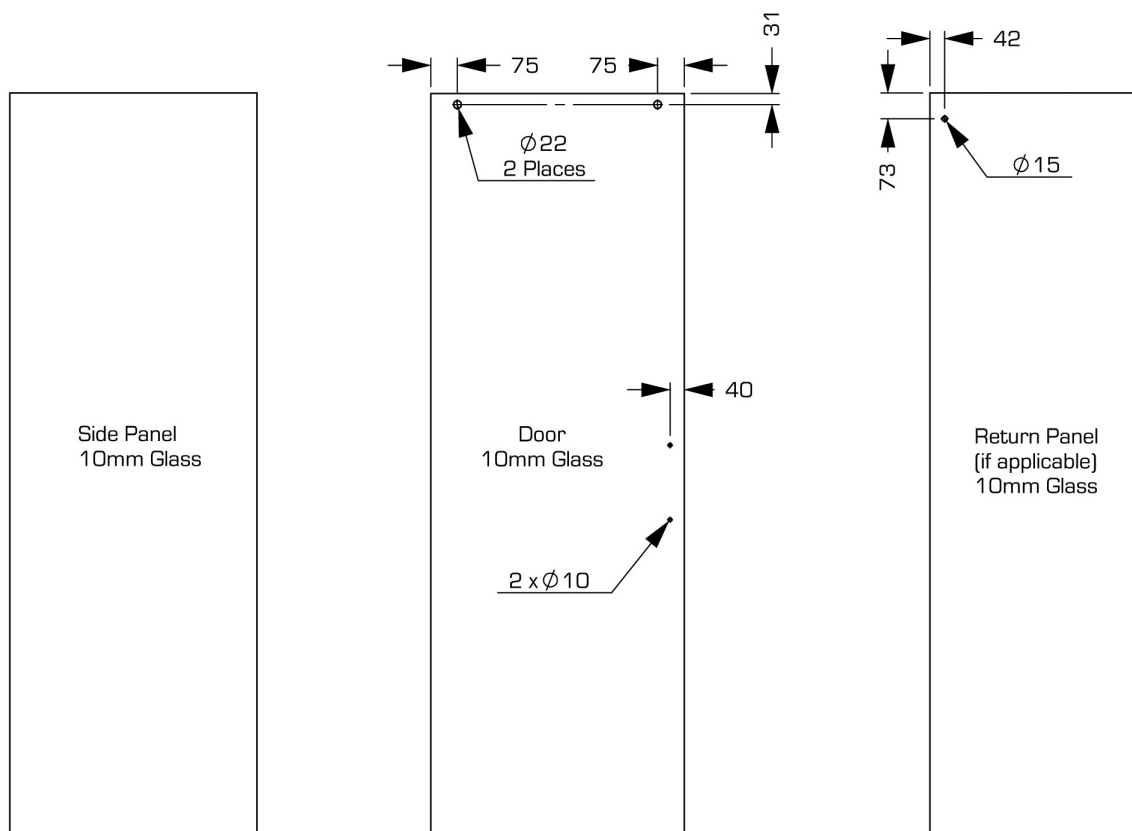
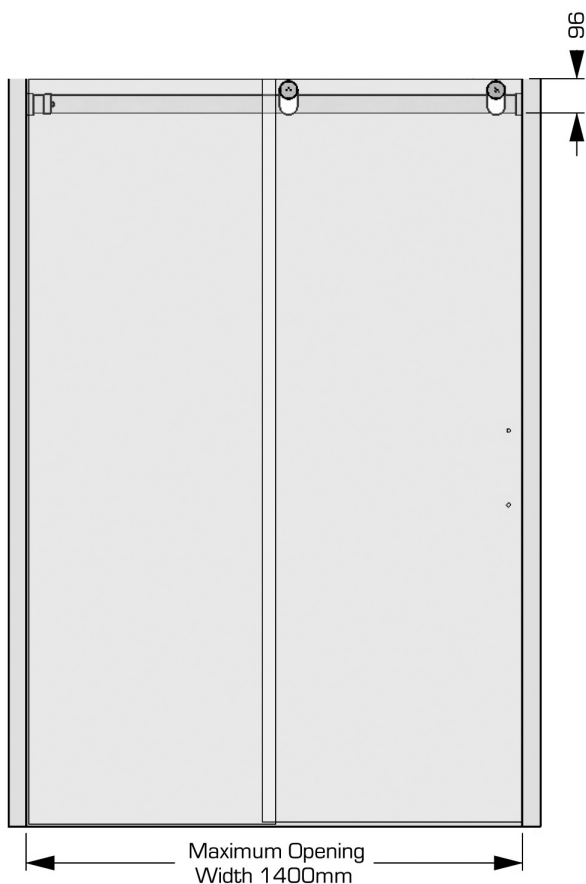

EUROROLLER RS10 SLIDING SYSTEM

RS10-2SD 2m track, for single door

RS10-4SD 4m track, for single door

RS10-4DD 4m track, for double door

AVAILABLE FINISH

- Rollers - polished or satin stainless steel
- Track - satin stainless steel

TECHNICAL DETAILS

Each pack includes: Bottom Track (either 2m or 4m), Rollers & Stops, Felt brush seal (for channel),

COM1 top channel guide (either 2m or 4m) and 2x COM3 End caps

Two rollers & two stops supplied per door

Suits 10mm and 12mm glass thickness

Max load 150kg per door

Please contact us for package information for side panel solutions and refer to our website for further technical details

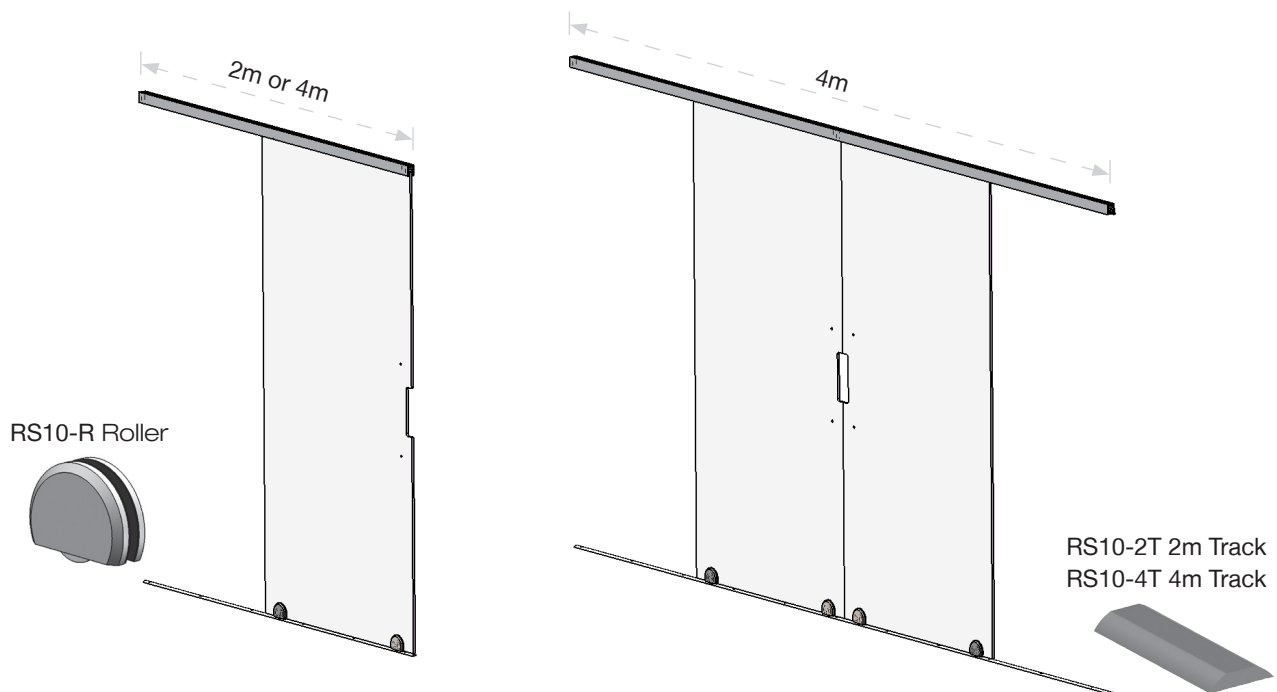

RS10-2SD single door 2m track
RS10-4SD single door 4m track

RS10-4DD double door 4m track

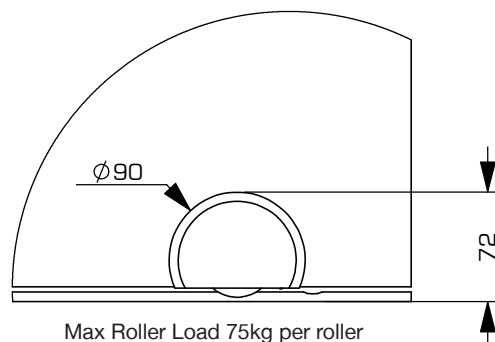

RS10-R Roller detail

**EUROROLLER RS10 SLIDING SYSTEM
GLASS DETAIL**

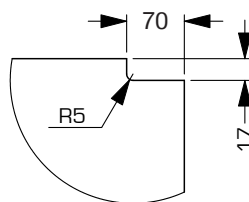
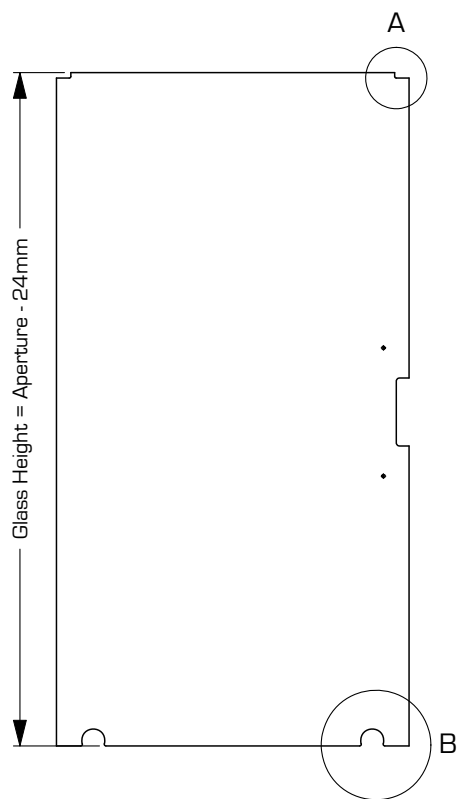

Stop - glass cutout detail

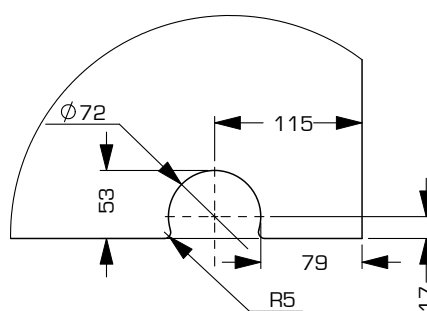

Roller - glass cutout detail

RS10 CROSS SECTION DETAIL

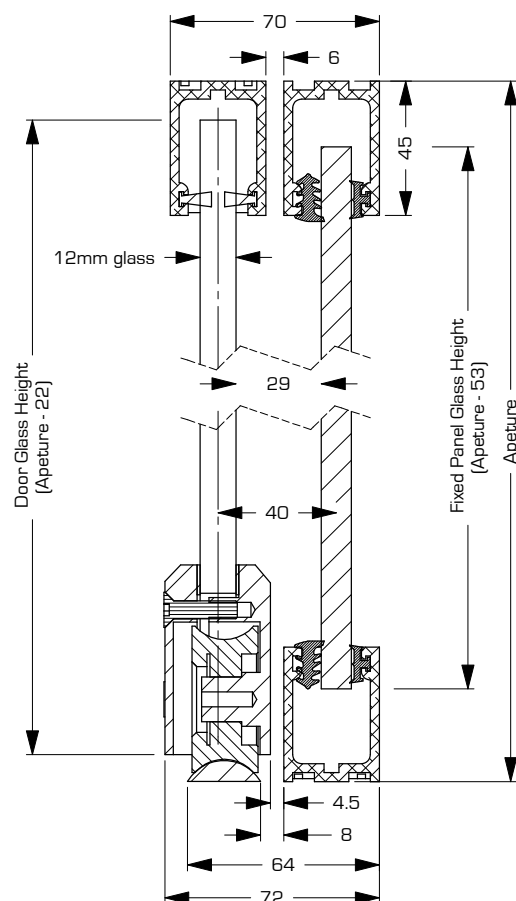
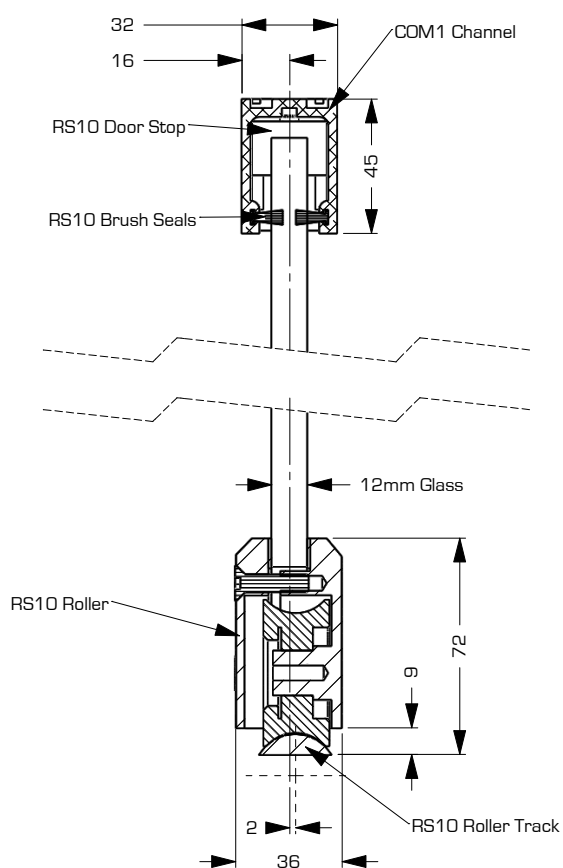

POINT FIX SLIDING SYSTEM

AVAILABLE FINISH

- Satin stainless steel

SS1 Tube top rail

TECHNICAL DETAILS

Cut to size per 1M
Includes 2 ends caps



SS3R/SS3F Glass hanger, round bar/flat bar

TECHNICAL DETAILS

Two required per door
Adjustable to suit 10mm and 12mm glass

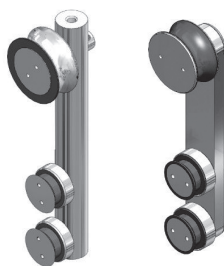

Glass detail

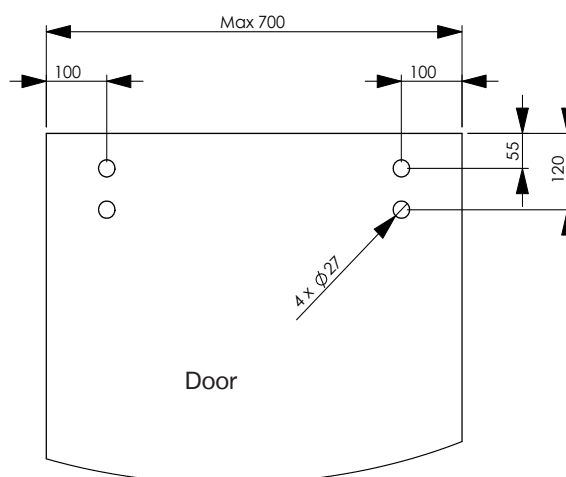

SS4 Wall anchor for SS1 tube



SS5 Glass mount clamp



SS6 Wall mount clamp

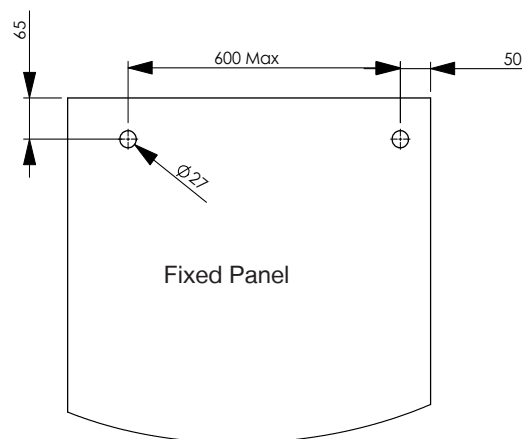

SS7R Stop

TECHNICAL DETAILS

SS7R = Round with spring stop
SS7FL = Flat stop (left hand)
SS7FR = Flat stop (right hand)



SS7R



SS7FL or SS7FR

(please specify left or right; left hand shown)

SSG10 Floor guide

TECHNICAL DETAILS

For 10mm glass
Clips on to the channel
No fixings required

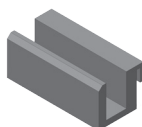

SS9 Sliding door finger pull

TECHNICAL DETAILS

Glass hole size 48mm
58mm o/a dia
Fits 8mm and 10mm glass



SS8 Floor guide

TECHNICAL DETAILS

Adjustable to suit 8mm, 10mm
or 12mm glass
Base thickness is 6mm

