

PRADIS CLAMP	B2
ANZIO FLOOR MOUNT CHANNEL	B3
LUGANO FACE FIX CLAMP	B4
MONACO FLOOR MOUNT CLAMP	B5
EUROANCHOR DISCS & SPACERS	B6 - B8
MILANO EUROPOSTS	B9
EUROBRACE & MINIPOSTS	B10 - B11
HANDRAILS & HANDRAIL BRACKETS	B12 - B18
BRACKETS & CLAMPS	B19 - B20
VIENNA HYDRAULIC HINGE & LATCH	B21 - B22
POOL GATE DOOR PIVOTS	B23
CABANA SLIDING BALUSTRADE BALCONY SCREEN	B24 - B25

**PRADIS Face mounted clamp
EZ1**

AVAILABLE FINISHES

- Satin anodised aluminium
- Selected powdercoat, lead time applies

TECHNICAL DETAILS

Using a single fixing bolt PRADIS can be fixed to the following different substrate types;

- Concrete
- Steel
- Timber - lag screw and bolt through

Supporting clamp can be anotec powder-coated with 10yr warranty

PS1 available on request

PRADIS is designed to take Viridian toughened or Viridian toughened laminated safety glass

Suitable for glass thickness from 12mm to 22.38mm

(can be adapted to take other glass thicknesses - upon request)

Suitable for;

Balustrade - Residential Occupancies A, A (other) & C3

Balustrade - Commercial Occupancies C3, B, E, C1/C2 and D

Balustrade - Commercial Occupancy C5, Specific design is required

(Based on barrier loads from AS/NZS1170.1: 2002)

Pool fencing and wind breaks

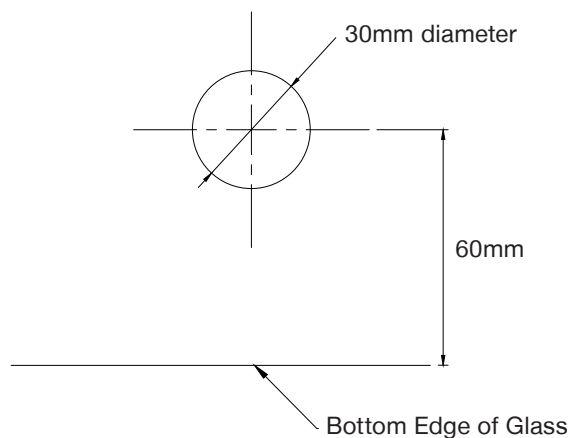
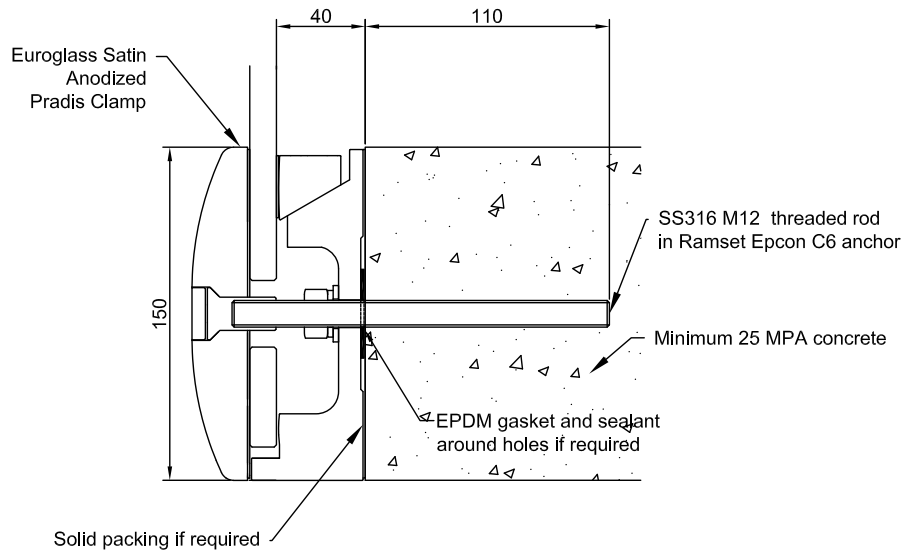

ANZIO Residential and Commercial Floor Mount Channel ETB

AVAILABLE FINISHES

- Mill finish
- Silver Pearl powdercoat
- Selected powdercoat, lead time applies

TECHNICAL DETAILS

1.25m, 2.5m and 5m stock lengths

Fixing kits available for the following different substrate types;

- Concrete

- Timber

Supplied complete with clamping kits, fixing sets and cover plates

Supplied with predrilled holes; 100mm in and 200mm ctc

ANZIO glass clamp kits are placed every 400mm ctc and no more than 200mm in from the edge of the glass

Base channel and cover plate is anotec powder-coated with 10yr warranty

PS1 available on request

Suitable to be used with;

Viridian 12mm, 15mm toughened safety glass or 13.5mm, 17.5mm toughened laminated safety glass

Rated up to a very high wind zone 1.76 kPa or less

Designed for;

- Balustrade Residential Occupancies A & C3
- Balustrade Commercial Occupancies B, E, C3, C1/C2 & D
(Based on barrier loads from AS/NZS1170.1)
- Pool fencing
- Wind breaks

Refer to our website for technical data sheets and fixing requirements

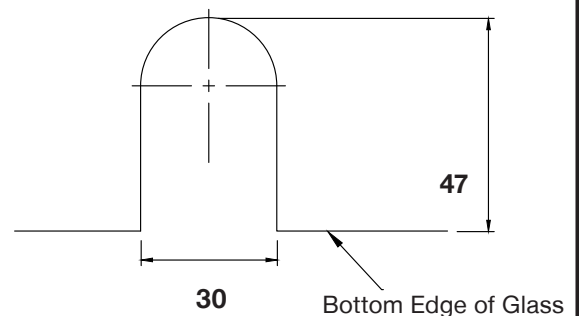
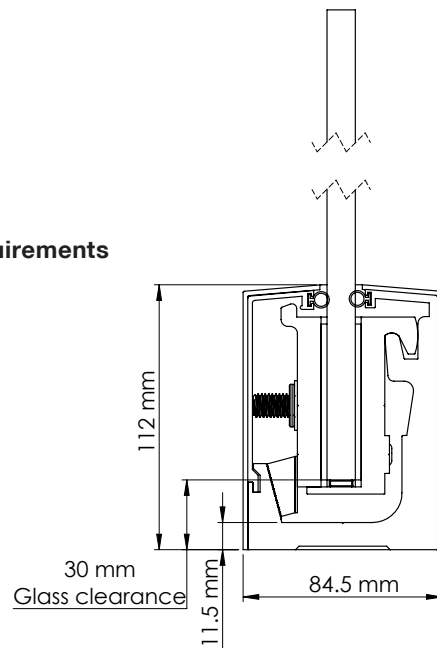
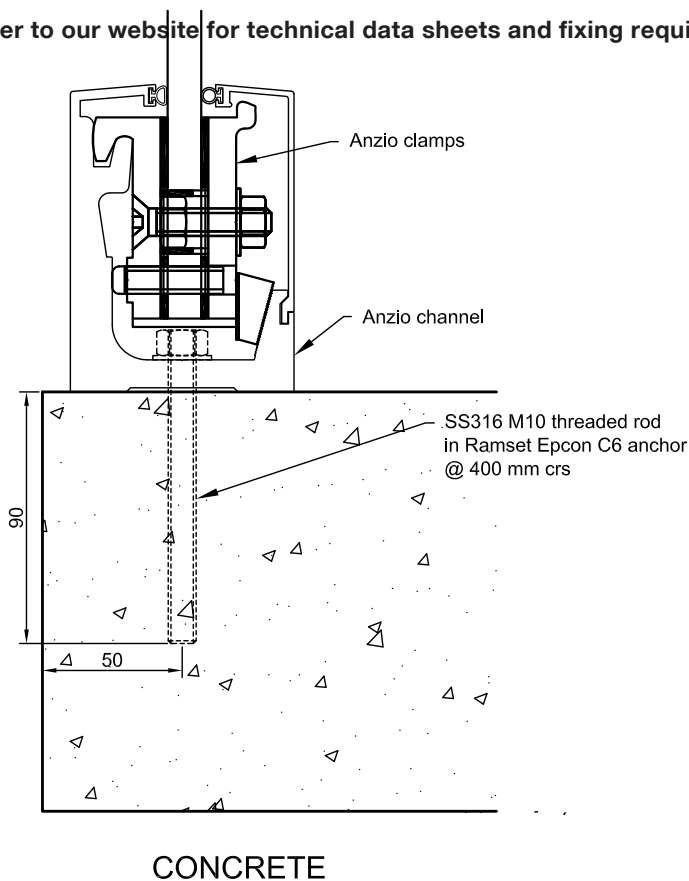
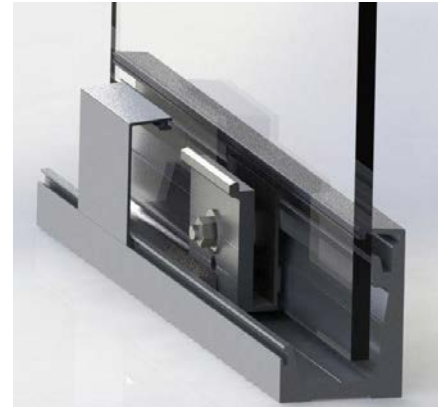

Glass Cut Out Detail

**LUGANO Residential Face Fix Channel
EFC**

AVAILABLE FINISHES

- Mill
- Silver Pearl powdercoat
- Selected powdercoat, lead time applies

TECHNICAL DETAILS

1.2m, 2.4m and 4.8m stock lengths

Fixing kits available for the following different substrate types;

- Concrete
- Steel
- Bolt through timber fix
- Lag screw timber fix

Suitable for 12mm toughened and 13.5mm laminated glass

Recommended installation tools available

End, internal and external corner caps available

No glass cut outs or holes required

Supporting base channel is anotec powder-coated with 10yr warranty

PS1 available on request

Suitable to be used with;

Viridian 12mm toughened or 13.5mm toughened laminated safety glass

Rated up to a very high wind zone 1.76 kPa or less

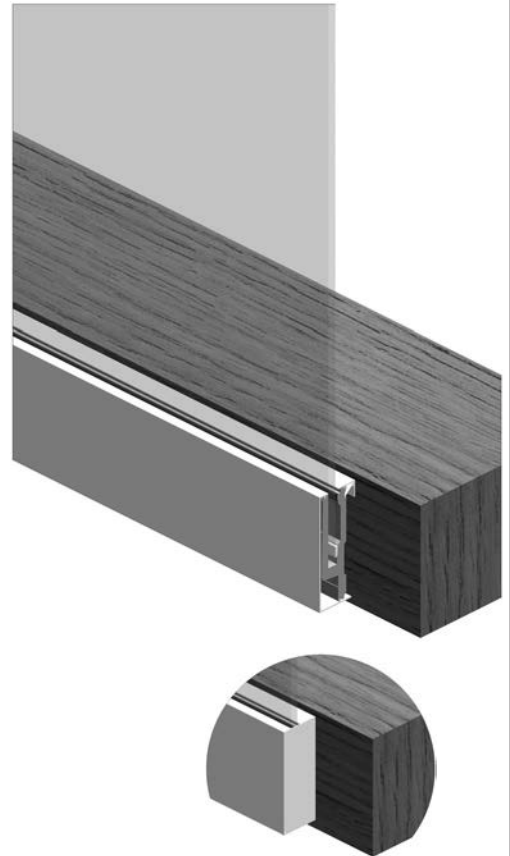

Designed for;

Balustrade - Residential Occupancies A & C3

Balustrade - Commercial Occupancy C3 (with the use of a interlinking rail)

(Based on barrier loads from AS/NZS1170.1)

Pool fencing protecting a fall of 1 metre or more

Pool fencing

Refer to our website for further details and fixing requirements

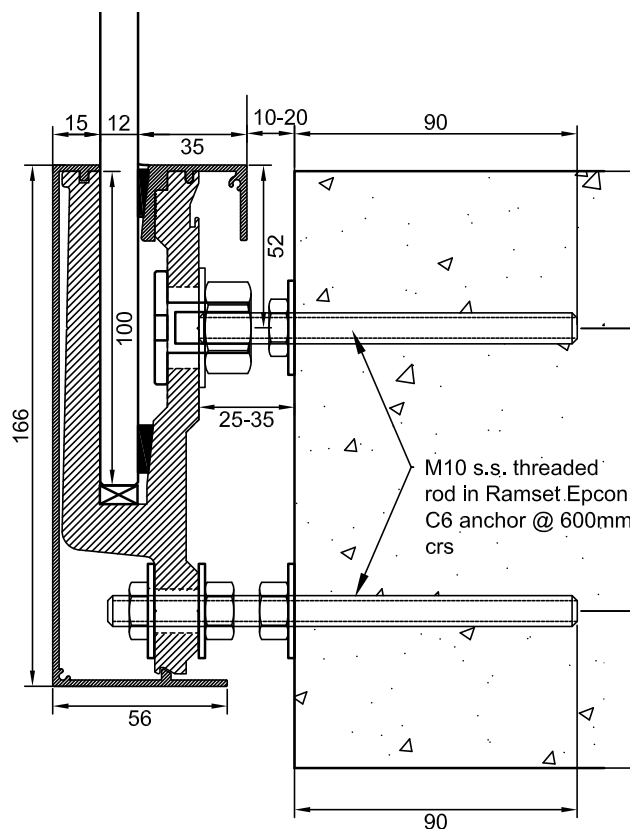

Concrete fixing

**MONACO Commercial Face Fix Clamp
EGL**

AVAILABLE FINISHES

- Mill
- Silver Pearl powdercoat
- Selected powdercoat, lead time applies

TECHNICAL DETAILS

1.2m, 2.4m and 4.8m stock lengths

SETS available for the different fixing options:

- Concrete fix
- Steel fix
- Bolt through timber fix

Suitable for 15mm and 19mm toughened
and 17.5mm and 21.5mm laminated glass

Recommended installation tools available

End, internal and external corner caps available

Glass cut-out required

Supporting base channel is anotec powder-coated with 10yr warranty

PS1 available on request

Rated up to a ULS wind pressure of 3.0 kPa or less

Designed for;

Balustrade - Residential Occupancies A & C3

Balustrade - Commercial Occupancies B, E, C1, C2, D & C3

(Based on barrier loads from AS/NZS1170.1)

Pool fencing protecting a fall of 1 metre or more

Pool fencing

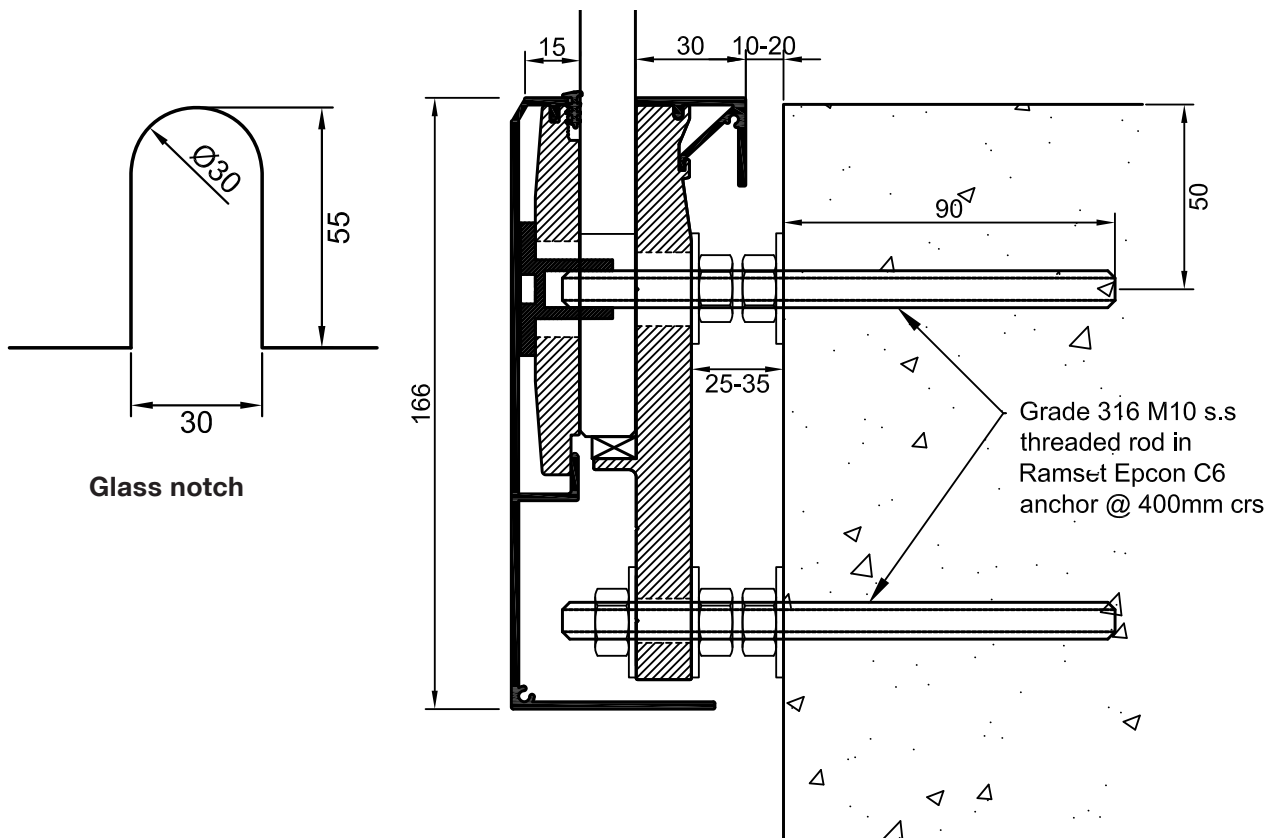
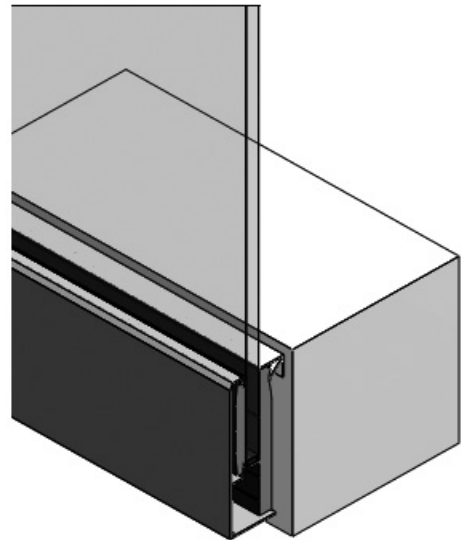

Glass notch

Concrete fixing

EUBFSD50/51 Euroanchor 50mm stepped disc

EUBFSD50 includes 25mm thick spacer / EUBFSD51 includes 10mm thick spacer

AVAILABLE FINISHES

- Satin anodised
- Polished stainless steel
- Satin stainless steel

TECHNICAL DETAILS

Manufactured in 316 grade stainless steel

Anodised to over 20 µm

The substrate material can be concrete, steel or timber

Includes washer, PVC sleeve & fixing (please specify either lag screw or threaded rod)

Glass fixing hole 26mm dia

25mm spacer can be threaded M10 or 10.5mm through hole (specify upon order)

Fixing centres as per PS1

PS1 available on request

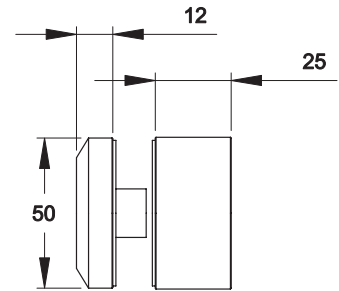

EUBFSQ Euroanchor 50mm square stepped disc

AVAILABLE FINISHES

- Polished stainless steel
- Satin stainless steel

TECHNICAL DETAILS

Manufactured in 316 grade stainless steel

The substrate material can be concrete, steel or timber

Includes washer, PVC sleeve & fixing (please specify either lag screw or threaded rod)

Glass fixing hole 26mm dia

Fixing centres as per PS1

PS1 available on request

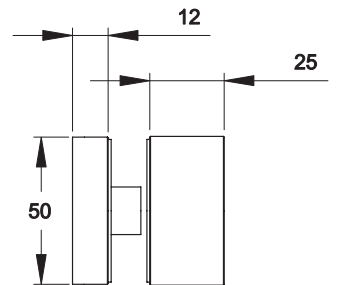

EUBFCS Euroanchor 50mm countersunk stepped disc

AVAILABLE FINISHES

- Polished stainless steel
- Satin stainless steel

TECHNICAL DETAILS

Manufactured in 316 grade stainless steel

The substrate material can be concrete, steel or timber

10mm and 25mm spacers available

Includes washer, PVC sleeve & fixing (please specify either lag screw or threaded rod)

Glass fixing hole 22mm dia

25mm spacer threaded M10

M10 x 35 countersunk hex bolt

Fixing centres as per PS1

PS1 available on request

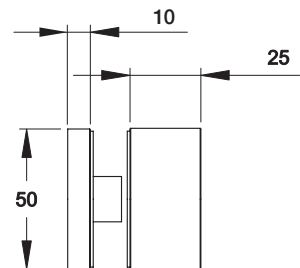

EUBFSQD Euroanchor rectangular stepped disc

AVAILABLE FINISHES

- Polished stainless steel
- Satin stainless steel

TECHNICAL DETAILS

Manufactured in 316 grade stainless steel

The substrate material can be concrete, steel or timber

Double 25mm spacer 10.5mm through hole

Includes washer, PVC sleeve & fixing (please specify either lag screw or threaded rod)

Glass fixing hole 26mm dia

Fixing centres as per PS1

PS1 available on request

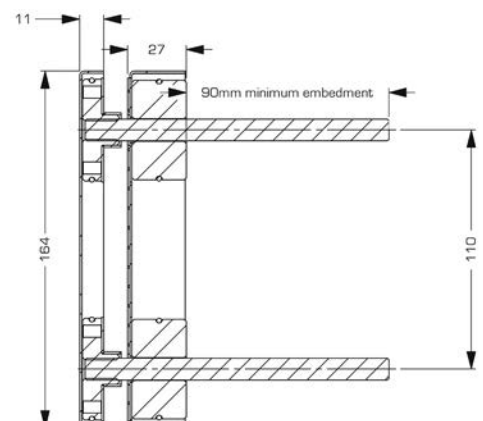

EUBFSD52 Euroanchor 50mm stepped disc with a 10mm thick stair stringer spacer

EUBFSD53 Euroanchor 50mm stepped disc with a 25mm thick stair stringer spacer

AVAILABLE FINISHES

- Polished stainless steel
- Satin stainless steel

TECHNICAL DETAILS

Manufactured in 316 grade stainless steel

Centre hole of the spacer is threaded and countersunk to suit M10 countersunk hex bolt

3x countersunk fixing holes to suit 14G countersunk self tapping screw

Includes washer, PVC sleeve & fixings;

EUBFSD52 is supplied with 3x 14G x 50mm c/snk self tapping screws

EUBFSD53 is supplied with 3x 14G x 60mm c/snk self tapping screws

Glass fixing hole 26mm dia

Designed for timber stringers

Fixing centres as per PS1

PS1 available on request



Important Note:

EUBFSD52 and EUBFSD53 Euroanchors are only suitable for residential occupancy A and internal stair barriers within detached dwellings and household units.

EUBFSD52 Detail

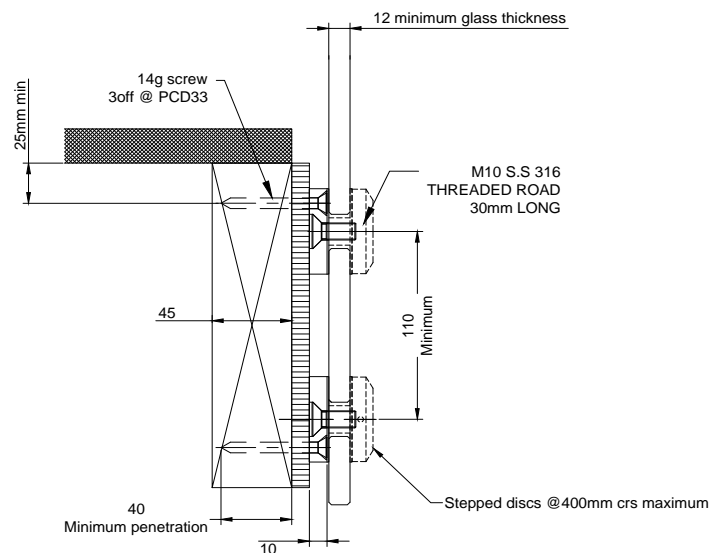

EUBFSD53 Detail

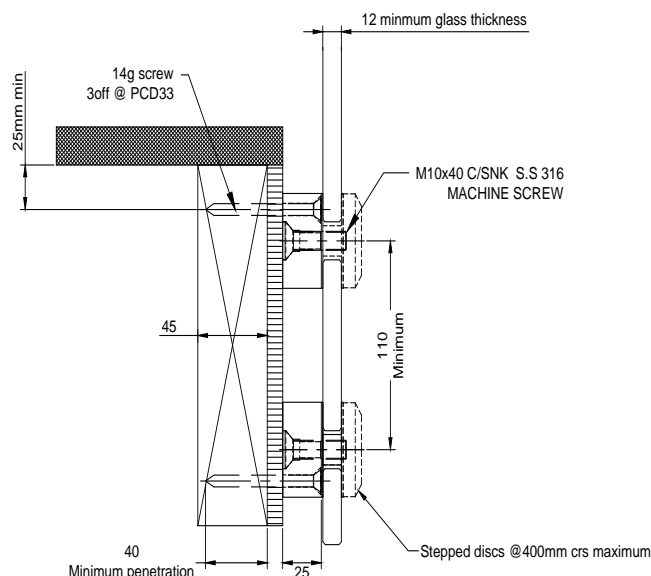

**TIMBER
FOR INTERNAL INSTALLATION ONLY**

SP5025T and SP5025 Spacers

AVAILABLE FINISHES

- Satin anodised
- Polished stainless steel
- Satin stainless steel

TECHNICAL DETAILS

SP5025T - Threaded M10 hole
SP5025 - 10.5mm dia. through hole

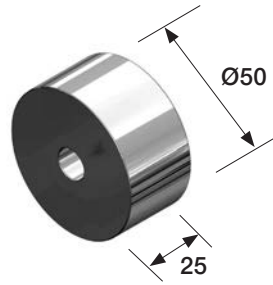

STSP25 and STSP10 Stair stringer spacer

AVAILABLE FINISHES

- Polished stainless steel
- Satin stainless steel

TECHNICAL DETAILS

Centre hole is threaded and countersunk,
to suit M10 countersunk hex bolt
3x countersunk fixing holes to suit 14G countersunk screws
STSP25 = 25mm thick spacer, STSP10 = 10mm thick spacer
Fixings sold separately

Important Note: STSP spacers can only be used for residential occupancy A and internal stair barriers within detached dwellings and household units.

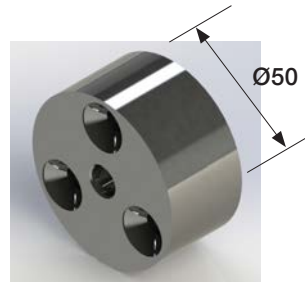

SPC5010 Countersunk disc or Spacer

AVAILABLE FINISHES

- Polished stainless steel
- Satin stainless steel

TECHNICAL DETAILS

Drilled and countersunk
To suit M10 countersunk hex bolt

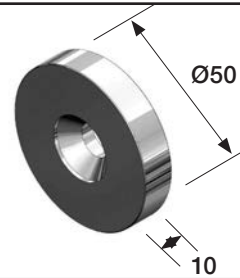

SD50M10 Stepped disc

AVAILABLE FINISHES

- Satin anodised
- Polished stainless steel
- Satin stainless steel

TECHNICAL DETAILS

M10 threaded blind hole

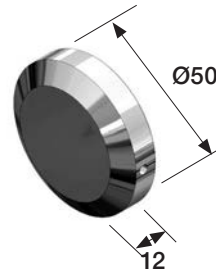

SP505WB Weatherboard shim

AVAILABLE FINISHES

- Satin anodised
- Polished stainless steel
- Satin stainless steel

TECHNICAL DETAILS

8 degree angle
12mm thick tapered to 5mm
10.5mm dia. through hole

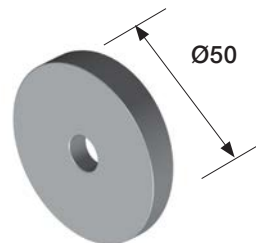

SPG3210/12 Gib spacers

AVAILABLE FINISHES

- Plastic
- Aluminium

TECHNICAL DETAILS

10mm thick plastic or aluminium
12mm thick plastic or aluminium

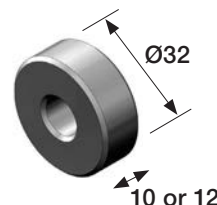

MILANO POST Semi-Frameless Residential Balustrade Posts ERP

AVAILABLE FINISHES

- Silver Pearl powdercoat
- Selected powdercoat

TECHNICAL DETAILS

Based on design loads from
AS/NZS 1170.1 and a max uls wind
pressure of 1.76 kPa (very high wind zone)
Rated for Residential occupancy A and C3
Suited for Viridian 'Balustrade 100' 10mm toughened
safety glass or 11.5mm toughened laminate glass
Fixed at 1650mm centres
Maximum height 1100mm
Maximum glass overhang 500mm
PS1 available on request
Refer to our website for further details

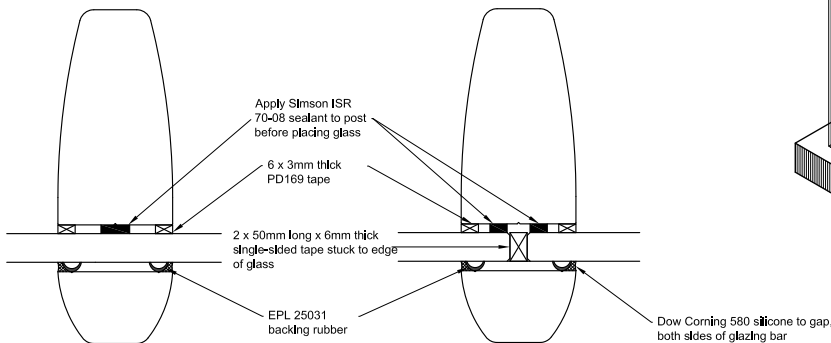
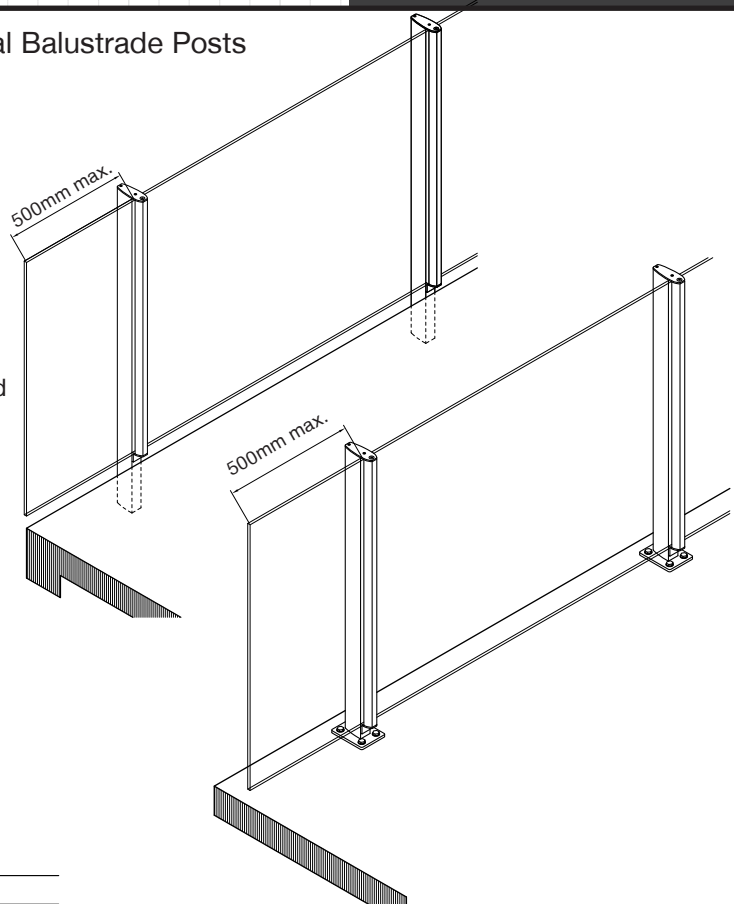

NO GLASS JOINT

GLASS JOINT

MILANO POST Semi-Frameless Commercial Balustrade Posts

AVAILABLE FINISHES

- Silver Pearl powdercoat
- Selected powdercoat

TECHNICAL DETAILS

TCan be used in any commercial occupancy
Concrete or bolt through timber

PS1 available on request

Refer to our website for further details

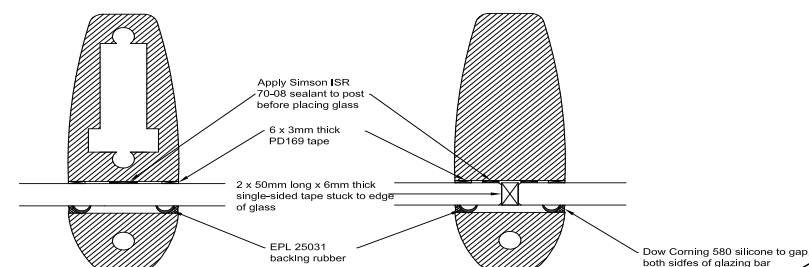
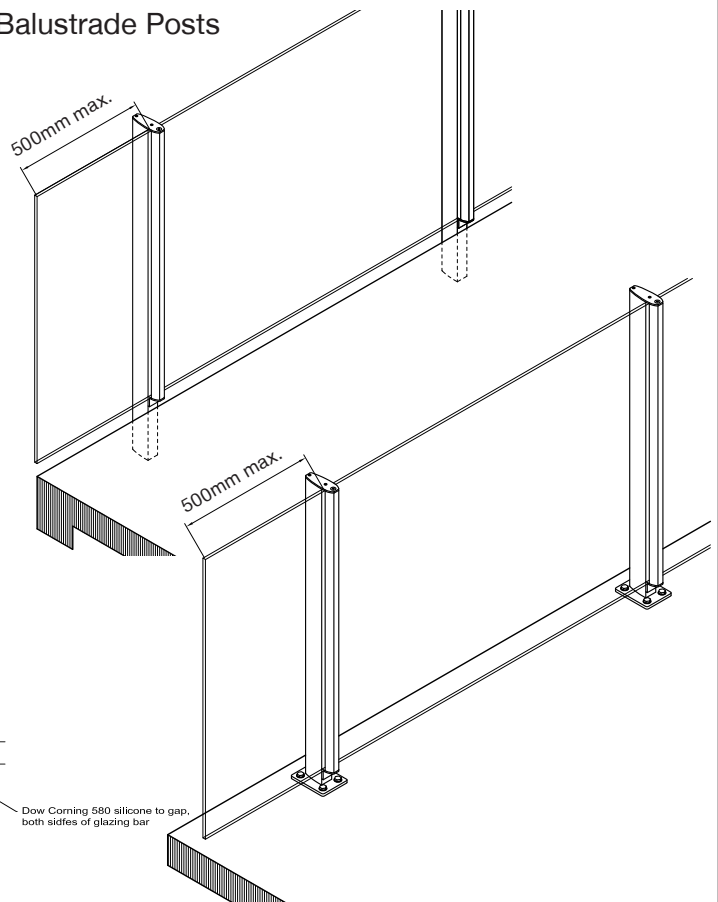

EB1 Eurobrace

AVAILABLE FINISHES

- Polished stainless steel
- Satin stainless steel

TECHNICAL DETAILS

Manufactured in 316 grade stainless steel

Suitable for 10, 12 and 15mm glass

Posts are set into concrete (Ø50mm hole) and affixed using SIKA or ROCKITE grout (to manufacturer's specifications)

26mm diameter holes in glass

45mm typical clearance from ground surface

Distance from inside face of glass and post centre is 40mm

PS1 available on request

Refer our website for further details

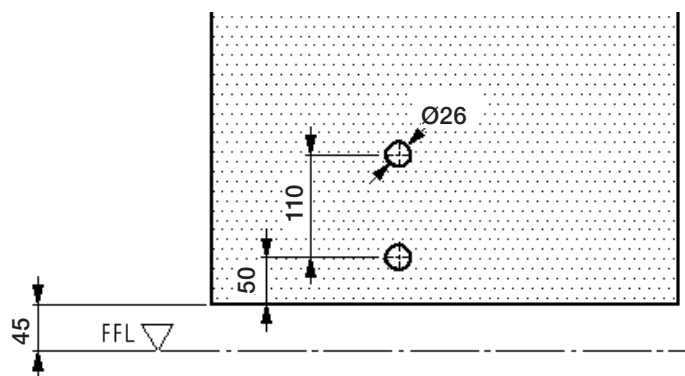
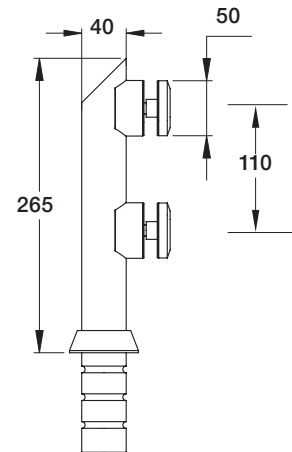

Glass Cut Out Detail

EB2 Eurobrace, square

AVAILABLE FINISHES

- Polished stainless steel
- Satin stainless steel

TECHNICAL DETAILS

Manufactured in 316 grade stainless steel

Suitable for 10, 12 and 15mm glass

Posts are set into concrete (Ø50mm hole) and affixed using SIKA or ROCKITE grout (to manufacturer's specifications)

26mm diameter holes in glass

45mm typical clearance from ground surface

Distance from inside face of glass and post centre is 32mm

PS1 available on request

Refer our website for further details

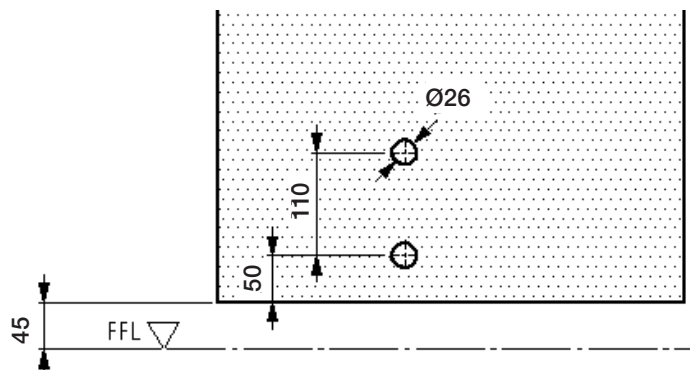
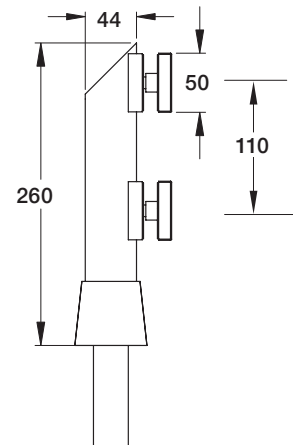
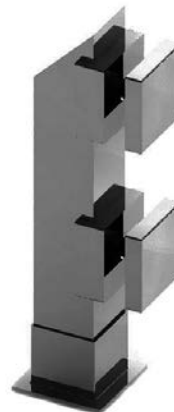

Glass Cut Out Detail

FMP250 Miniposts

AVAILABLE FINISHES

- Polished stainless steel
- Satin stainless steel

TECHNICAL DETAILS

Manufactured in 316 grade stainless steel

Suitable for 12 and 15mm glass

Mini posts are set 85mm into concrete (Ø60mm hole) and affixed using SIKA or ROCKITE grout (to manufacturer's specifications)

26mm diameter hole in glass

45mm typical clearance from ground surface

Optional Dress Ring or Cover Plate available

PS1 available on request

Refer our website for further details

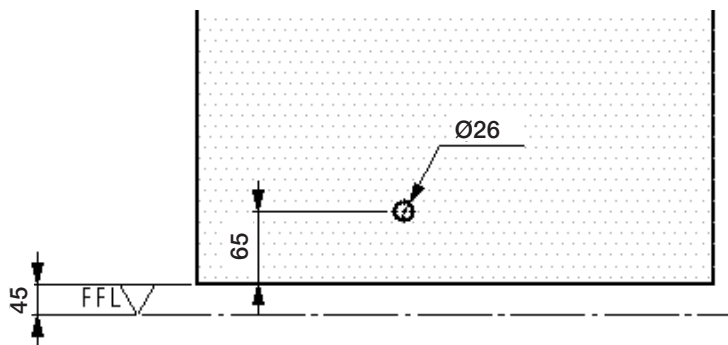
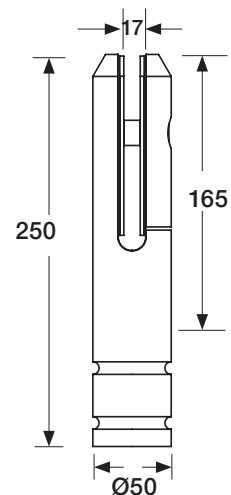

Glass Cut Out Detail



FMP250RING
80mm outside dia.
51mm inside dia.

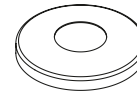

FMP250COVER
125mm outside dia.
51mm inside dia.
(matches FMP350 cover)

FMP350 Miniposts

AVAILABLE FINISHES

- Polished stainless steel
- Satin stainless steel

TECHNICAL DETAILS

Manufactured in 316 grade stainless steel

Suitable for 12 and 15mm glass

26mm diameter hole in glass

45mm typical clearance from ground surface

Posts can be fastened to concrete or wooden surfaces using 2 x M10 bolts/screws

PS1 available on request

Refer our website for further details

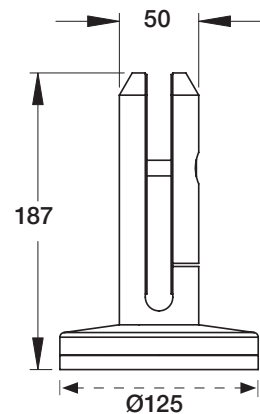

Ø90 PCD
4 holes

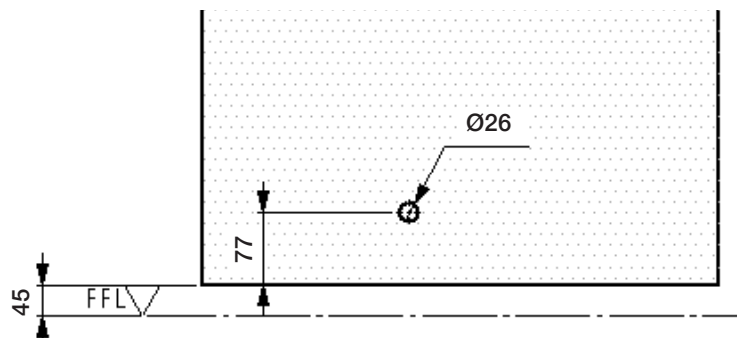
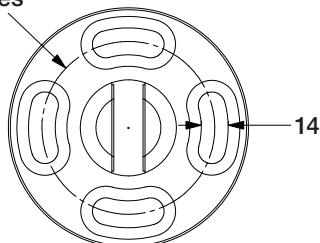

Glass Cut Out Detail

HRC1 Roundline Interlinking Handrail
2205 Duplex Stainless Steel Interlinking Handrail Capping

AVAILABLE FINISHES

- Polished stainless steel
- Satin stainless steel, lead time applies

TECHNICAL DETAILS

5.8m stock lengths

Glass width limits can be found on page B14

Easy to install using simple tools, no on site welding required

Roundline is easily attached to the glass using a compression fit rubber molding

Suitable for 12mm, 15mm and 19mm toughened safety glass

and 13.5mm and 17.5mm toughened laminated safety glass

Joiners, end caps and wall mount brackets are glued together using tube lock

Joiners need be located between the glass panes

Wall mount bracket requires a EPDM washer when penetrating

cladding, weatherboards and membrane surfaces

EPDM washers are sold separately (lead time applies)

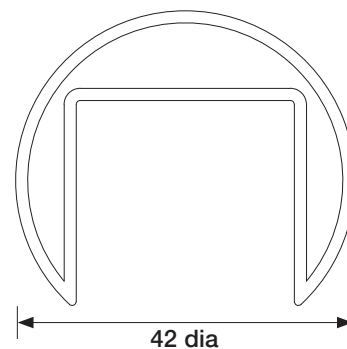

HRC1SJ
Straight Joiner



HRC1EC
End Cap

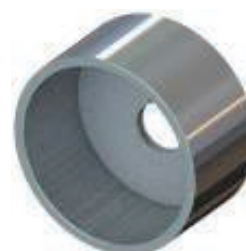

HRC1WA
Wall Anchor



HRC1C90
Cast 90deg Corner



HRC1VAJ
Vertical Adjustable Joiner



HRC1HAJ
Horizontal Adjustable Joiner

HRC2 Squareline Interlinking Handrail
2205 Duplex Stainless Steel Interlinking Handrail Capping

AVAILABLE FINISHES

- Polished stainless steel
- Satin stainless steel, lead time applies

TECHNICAL DETAILS

5.8m stock lengths

Glass width limits can be found on page B14

Easy to install using simple tools, no on site welding required

Squareline is easily attached to the glass using a compression fit rubber molding

Suitable for 12mm, 15mm and 19mm toughened safety glass

and 13.5mm and 17.5mm toughened laminated safety glass

Joiners, end caps and wall mount brackets are glued together using tube lock

Joiners need be located between the glass panes

Wall mount bracket requires a EPDM washer when penetrating

cladding, weatherboards and membrane surfaces

EPDM washers are sold separately (lead time applies)

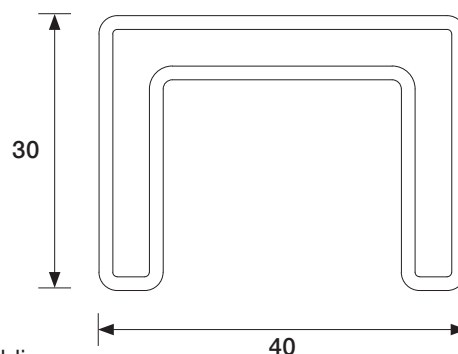

Range of components;

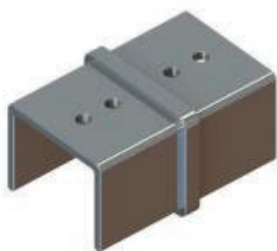

HRC2SJ
Straight Joiner



HRC2EC
End Cap

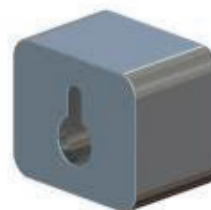

HRC2WA
Wall Anchor

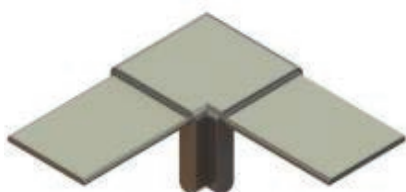

HRC2C90
Cast 90deg Corner

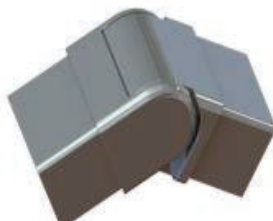

HRC2VAJ
Vertical Adjustable Joiner



HRC2HAJ
Horizontal Adjustable Joiner

HRC1 Roundline Interlinking Handrail
HRC2 Squareline Interlinking Handrail

TECHNICAL DETAILS - GLASS WIDTH LIMITS

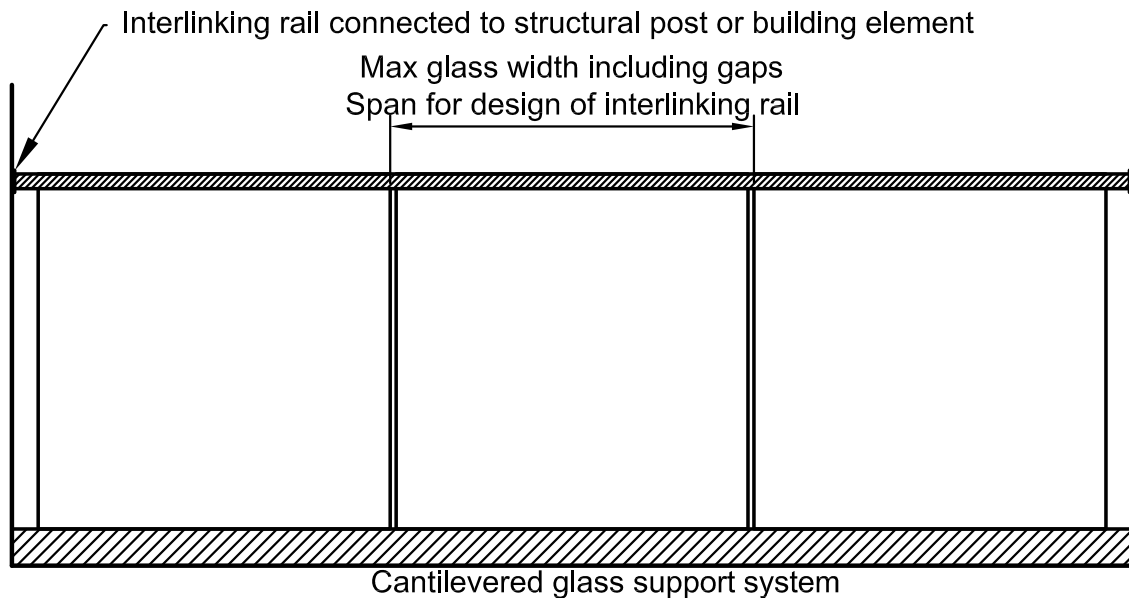

HRC1 Roundline Interlinking Handrail

Occupancy type A other and C3; Maximum glass width 2200mm

Occupancy type C1/C2 & D; Maximum glass width 1400mm

Occupancy type C5; Specific design is required

HRC2 Squareline Interlinking Handrail

Occupancy type A other and C3; Maximum glass width 2100mm

Occupancy type C1/C2 & D; Maximum glass width 1400mm

Occupancy type C5; Specific design is required

Notes;

- 1) These interlinking rails are designed to resist SLS design loads in the event of a single pane of glass breaking
- 2) Interlinking rail must be supported by each pane, structural post or other building element
- 3) Interlinking rail must be mechanically connected using joiners or welded together
- 4) Joiners or welds need be located between the glass panes
- 5) In the unlikely event of a glass pane breaking, the deflection of this interlinking rail under SLS design loads is restricted to $\text{span} / 60$
- 6) Specific design is required for occupancy type C5

HRC3 Archline

Aluminium Interlinking Handrail Capping

AVAILABLE FINISHES

- Mill
- Silver Pearl powdercoat
- Selected powdercoat, lead time applies

TECHNICAL DETAILS

5m stock lengths

Glass width limits can be found on page B16

Easy to install using simple tools, no on site welding required

Suitable for 12mm and 15mm toughened safety glass

and 13.5mm and 17.5mm toughened laminated safety glass

Interlinking capping is anotec powdercoated with a 10yr warranty

Joiners, end caps and wall mount brackets are supplied complete with screws

HRC3WM - wall mount bracket requires a EPDM washer when penetrating cladding, weatherboards and membrane surfaces. HRC3EPDM sold separately.

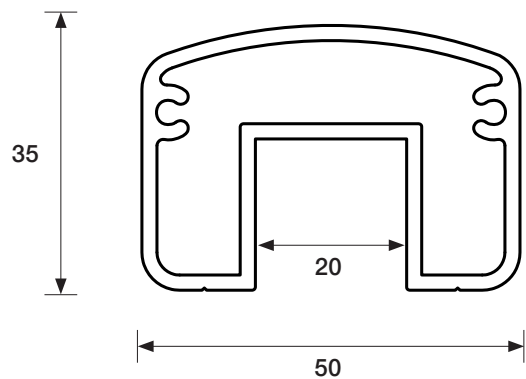

Range of components;

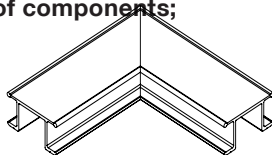

HRC3J90

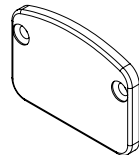

HRC3EC

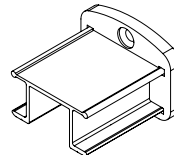

HRC3WM

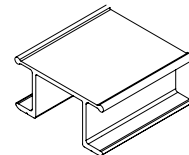

HRC3SJ

Joiner Installation Details

Joint in rail to be located between glass panes

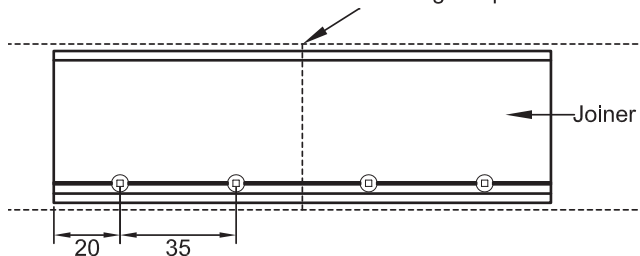

Straight joiner

HRC3SJ

Straight Joiner Connection Detail

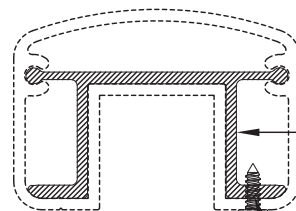

Wall, corner or
straight joiner

2 x 8 gauge screw
both sides of joint

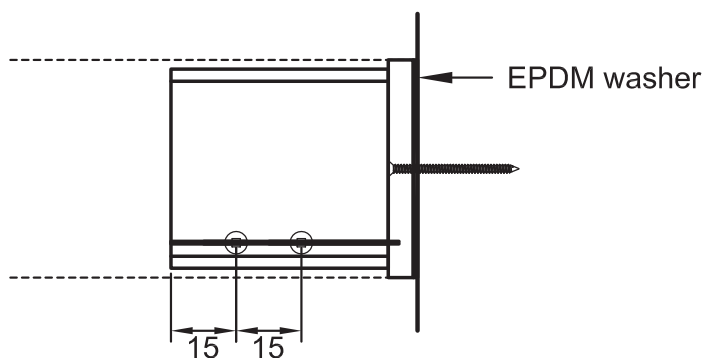

HRC3WM

Wall Mount Bracket Connection Detail

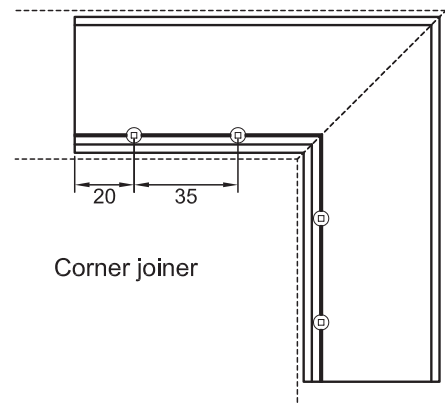

Corner joiner

HRC3J90

90deg Joiner Connection Detail

HRC3 Archline
Aluminium Interlinking Handrail Capping

Glass Mounting Detail

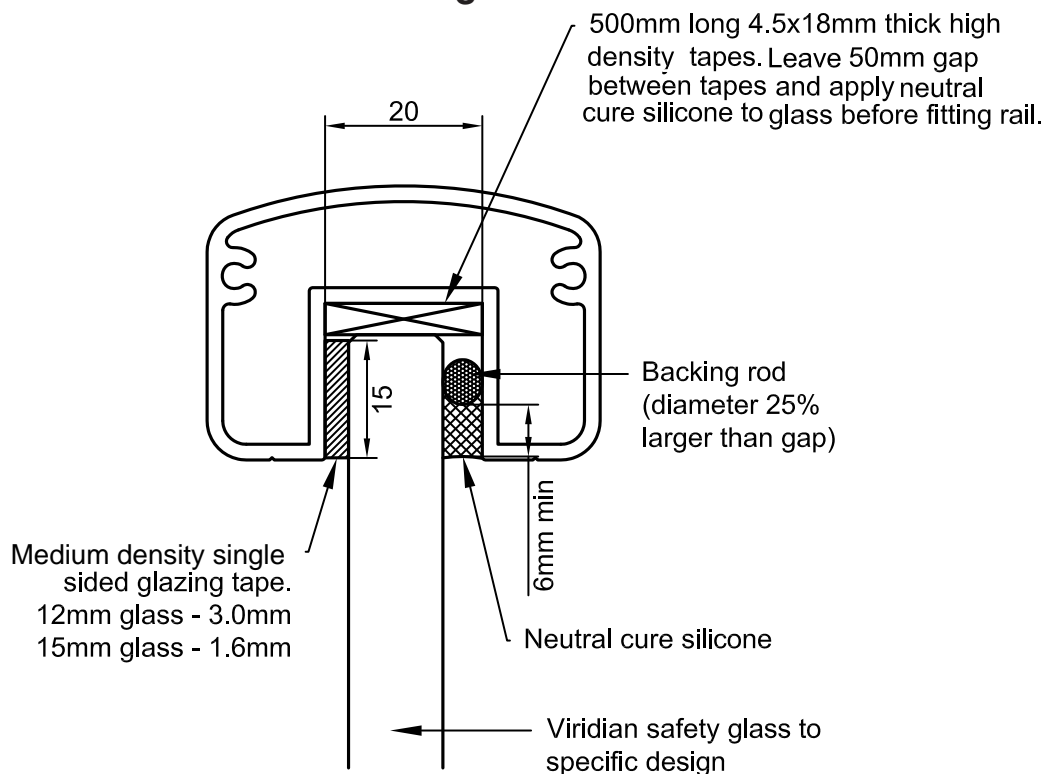

Glass Width Limits

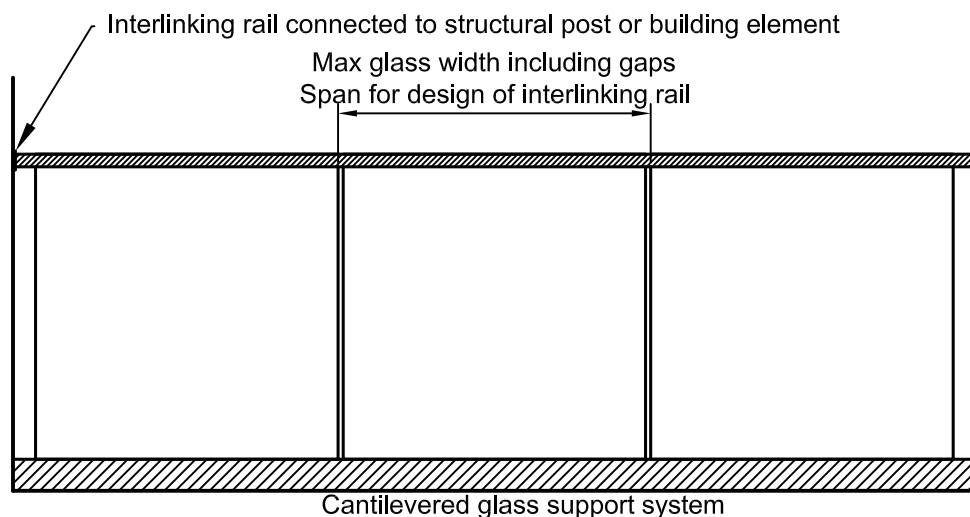

Occupancy type A other and C3; Maximum glass width 1850mm

Occupancy type C1/C2 & D; Maximum glass width 1000mm

Occupancy type C5; Specific design is required

Notes;

- 1) This interlinking rail is designed to resist SLS design loads in the event of a single pane of glass breaking
- 2) Interlinking rail must be supported by each pane, structural post or other building element
- 3) Interlinking rail must be mechanically connected using joiners or welded together
- 4) Joiners or welds need be located between the glass panes
- 5) In the unlikely event of a glass pane breaking, the deflection of this interlinking rail under SLS design loads is restricted to $\text{span} / 60$
- 6) Specific design is required for occupancy type C5

BH1 Slimline handrail & end cap

AVAILABLE FINISHES

- Mill finish
- Silver Pearl powdercoat
- Selected powdercoat (lead time applies)

TECHNICAL DETAILS

Meets AS1288-2006 for handrailing for glass balustrades that are over 1m in height and only fixed to the base
Complies with NZS4203:1992 for handrails
Suitable for 10mm and 12mm glass (specify when ordering)
Can be used for both interior and exterior applications
Designed for easy fitting, clips directly over the glass: no welding required and can be installed after glass is fitted



BH2
End Cap

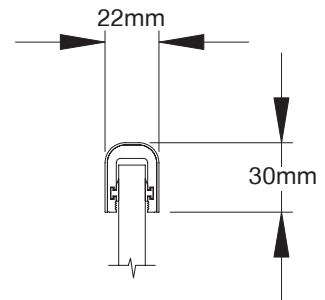

EUHB50 Handrail bracket

AVAILABLE FINISHES

- Polished stainless steel
- Satin stainless steel

TECHNICAL DETAILS

26mmØ hole in glass for EUHB50
Supplied 150mm high for on-site trimming

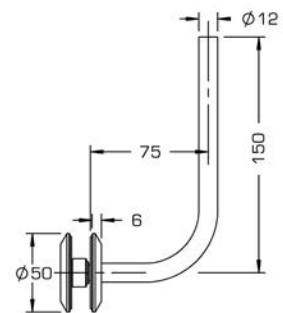

EUHB50SQ Handrail bracket, square

AVAILABLE FINISHES

- Polished stainless steel
- Satin stainless steel

TECHNICAL DETAILS

26mmØ hole in glass
Supplied 150mm high for on-site trimming

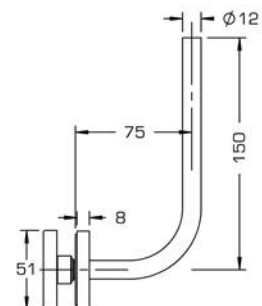

EUHBTf50 Handrail bracket timber fix

AVAILABLE FINISHES

- Polished stainless steel
- Satin stainless steel

TECHNICAL DETAILS

Designed for timber fixing
Supplied 150mm high for on-site trimming

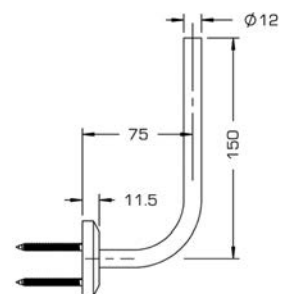

EUHBTf50SQ Handrail bracket timber fix, square

AVAILABLE FINISHES

- Polished stainless steel
- Satin stainless steel

TECHNICAL DETAILS

Designed for timber fixing
Supplied 150mm high for on-site trimming

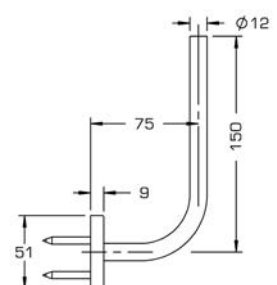

HBGM1 Round glass mounted handrail bracket

AVAILABLE FINISHES

- Polished stainless steel
- Satin stainless steel
- Custom finishes available upon request

TECHNICAL DETAILS

Made from 2205 Duplex stainless steel
Can be used with balustrades that
require a load supporting interlinking rail
26mmØ hole in glass

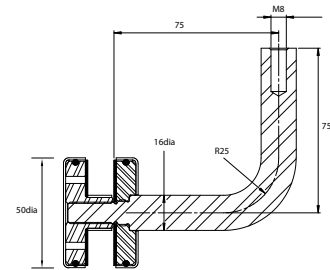
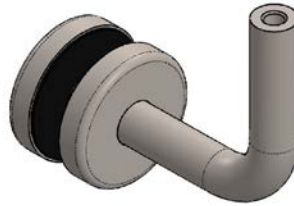

HBGM2 Square glass mounted handrail bracket

AVAILABLE FINISHES

- Polished stainless steel
- Satin stainless steel
- Custom finishes available upon request

TECHNICAL DETAILS

Made from 2205 Duplex stainless steel
Can be used with balustrades that
require a load supporting interlinking rail
26mmØ hole in glass

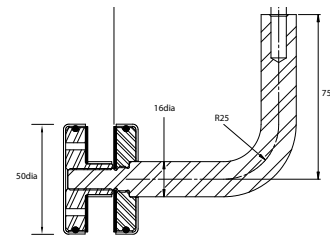
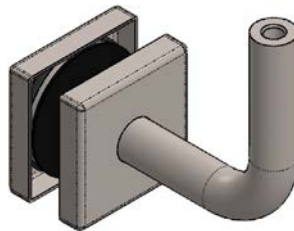

HBWM1 Round wall mounted handrail bracket

AVAILABLE FINISHES

- Polished stainless steel
- Satin stainless steel
- Custom finishes available upon request

TECHNICAL DETAILS

Made from 2205 Duplex stainless steel
Can be used with balustrades that
require a load supporting interlinking rail
Mounted to the wall using 3x countersunk
screws (screws not included)

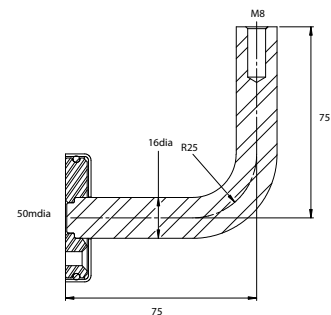
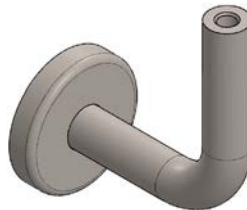

HBWM2 Square wall mounted handrail bracket

AVAILABLE FINISHES

- Polished stainless steel
- Satin stainless steel
- Custom finishes available upon request

TECHNICAL DETAILS

Made from 2205 Duplex stainless steel
Can be used with balustrades that
require a load supporting interlinking rail
Mounted to the wall using 3x countersunk
screws (screws not included)

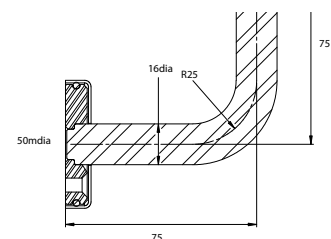
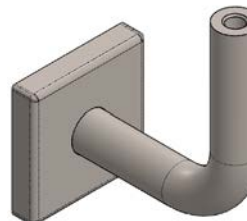

HBFS Handrail bracket fixing straddle

AVAILABLE FINISHES

- Polished stainless steel
- Satin stainless steel
- Custom finishes available upon request

TECHNICAL DETAILS

Made from 2205 Duplex stainless steel
Designed for mounting handrail sections to the handrail bracket
Supplied with M8 screw for fixing to the handrail bracket
Handrail section fixing screws are not included

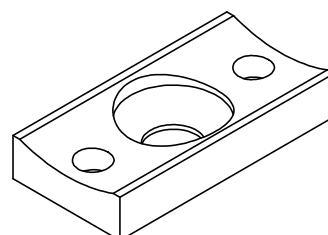

BCI/BCWM/BC90/BC135 Balustrade clamps

AVAILABLE FINISHES

- Polished stainless
- Satin stainless

TECHNICAL DETAILS

Suitable for 12mm glass

316 grade stainless steel

Supplied with rubber gasket inserts

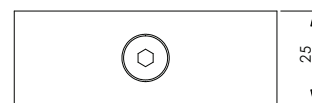

typical height



BCI
Glass-to-Glass

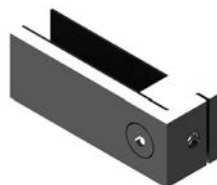

BCWM
Wall Mount

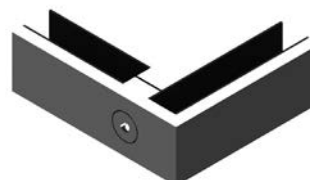

BC90
90° Corner

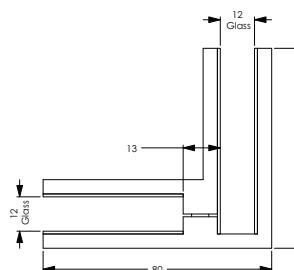
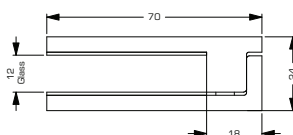
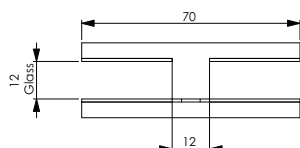

BB70/BB70SQ Balustrade brackets, wall mount

AVAILABLE FINISHES

- Polished stainless
- Satin stainless

TECHNICAL DETAILS

Suitable for 10 and 12mm glass

316 grade stainless steel

Round and square options

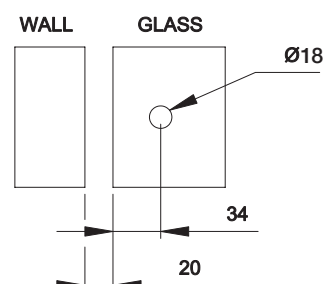

BB70



BB70SQ

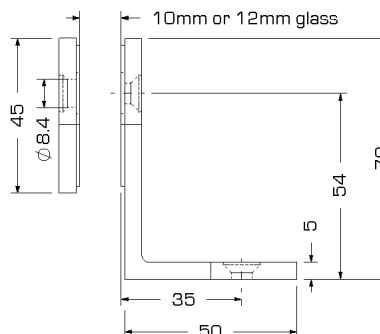

BBD70/BBD70SQ Balustrade brackets, glass/glass

AVAILABLE FINISHES

- Polished stainless
- Satin stainless

TECHNICAL DETAILS

Suitable for 10 and 12mm glass

316 grade stainless steel

Round and square options



BBD70



BBD70SQ

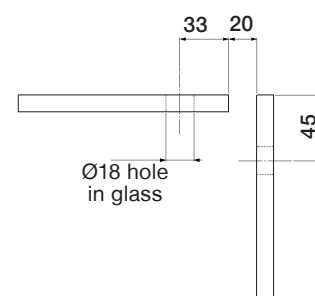

BCRD6/10, BCFD6/10, BCRS8/10, BCFS8/10 Glass clamps, post or wall mount

AVAILABLE FINISHES

- Polished stainless
- Satin stainless

TECHNICAL DETAILS

Options for 6, 8, 10 and 12mm glass

316 grade stainless steel

Round and square profiles

Flat back for fixing to square section and wall mounting, or round back to suit 50mm tubular post

BCRD6 Round back 6-8mm glass

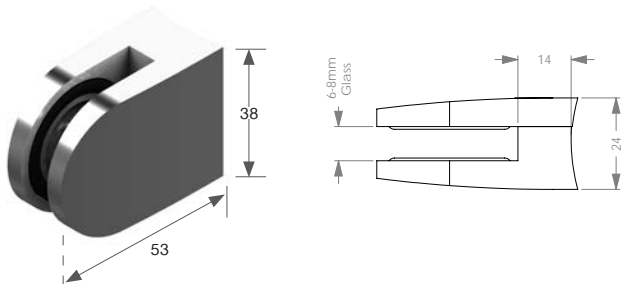

BCFD6 Flat back 6-8mm glass

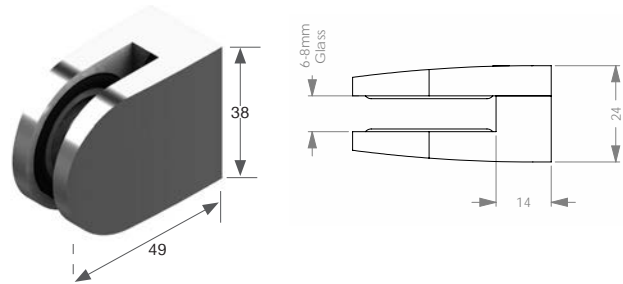

BCRS8 Round back 8-10mm glass

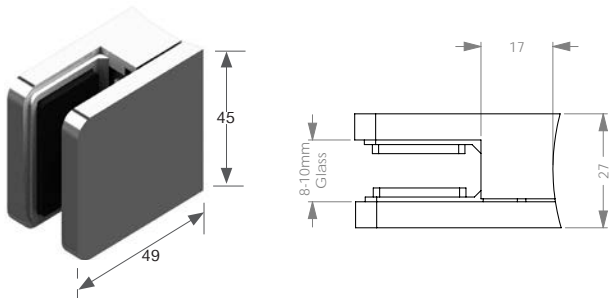

BCFS8 Flat back 8-10mm glass

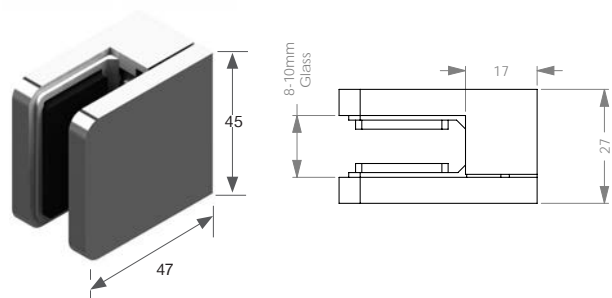

BCRD10 Round back 10-12mm glass

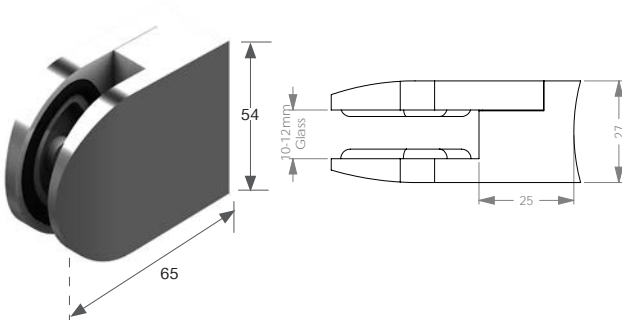

BCFD10 Flat back 10-12mm glass

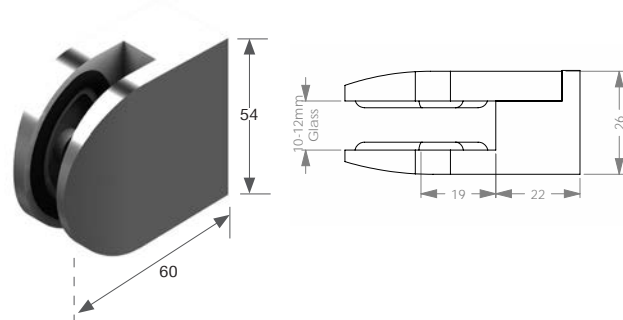

BCRS10 Round back 10-12mm glass

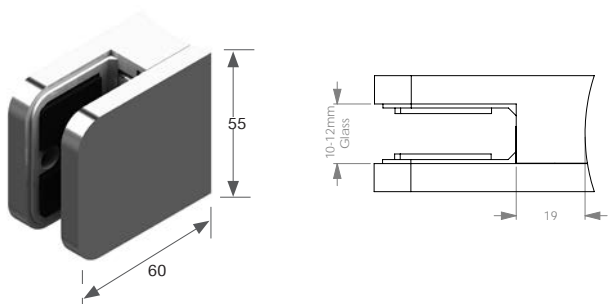

BCFS10 Flat back 10-12mm glass

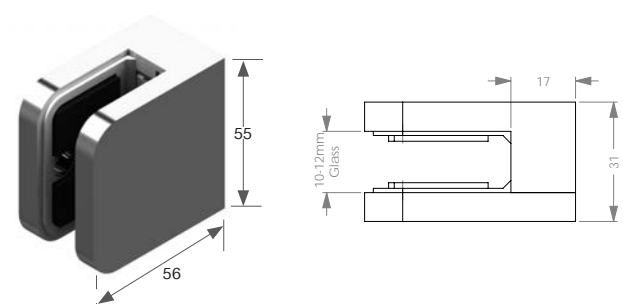

EH1NHO Glass to wall hydraulic hinge

AVAILABLE FINISHES

- Polished stainless steel, marine grade 316

TECHNICAL DETAILS

Made from aluminium and stainless steel
Hinge opening angle 100°
Self-closing from any angle
Available as non-hold open (for pool environments)
and hold open (doors)
Non-hold open has an offset closed position to hold
the gate or door firmly shut, preventing rattle
Maximum recommended glass weight: 70kg
Maximum recommended door width: 900mm
Standard for 12mm glass, can be supplied for 10mm
or 15mm glass on request
Screw on each pivot block adjusts hydraulic closing speed

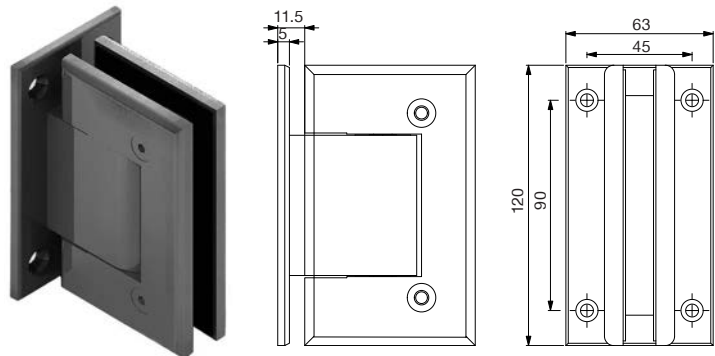

EH1LNHO Glass to wall hydraulic hinge, offset

AVAILABLE FINISHES

- Polished stainless steel, marine grade 316

TECHNICAL DETAILS

Made from aluminium and stainless steel
Hinge opening angle 100°
Self-closing from any angle
Available as non-hold open (for pool environments)
and hold open (doors)
Non-hold open has an offset closed position to hold
the gate or door firmly shut, preventing rattle
Maximum recommended glass weight: 70kg
Maximum recommended door width: 900mm
Standard for 12mm glass, can be supplied for 10mm
or 15mm glass on request
Screw on each pivot block adjusts hydraulic closing speed

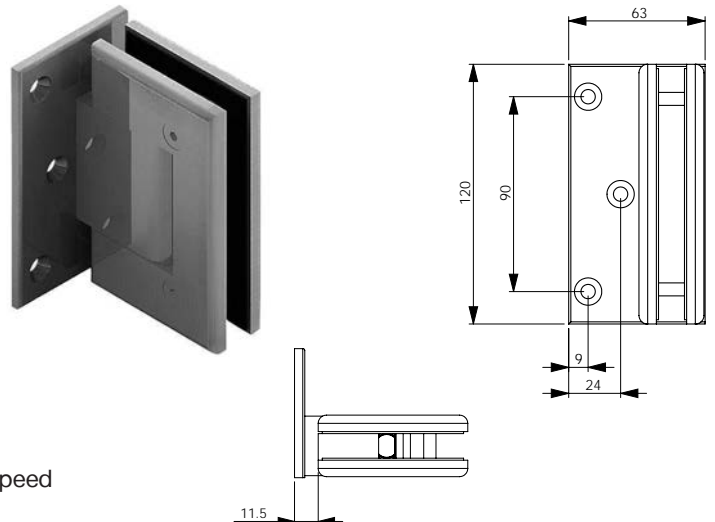

EH2NHO Glass to glass hydraulic hinge

AVAILABLE FINISHES

- Polished stainless steel, marine grade 316

TECHNICAL DETAILS

Made from aluminium and stainless steel
Hinge opening angle 100°
Self-closing from any angle
Available as non-hold open (for pool environments)
and hold open (doors)
Non-hold open has an offset closed position to hold
the gate or door firmly shut, preventing rattle
Maximum recommended glass weight: 70kg
Maximum recommended door width: 900mm
Standard for 12mm glass, can be supplied for 10mm
or 15mm glass on request
Screw on each pivot block adjusts hydraulic closing speed

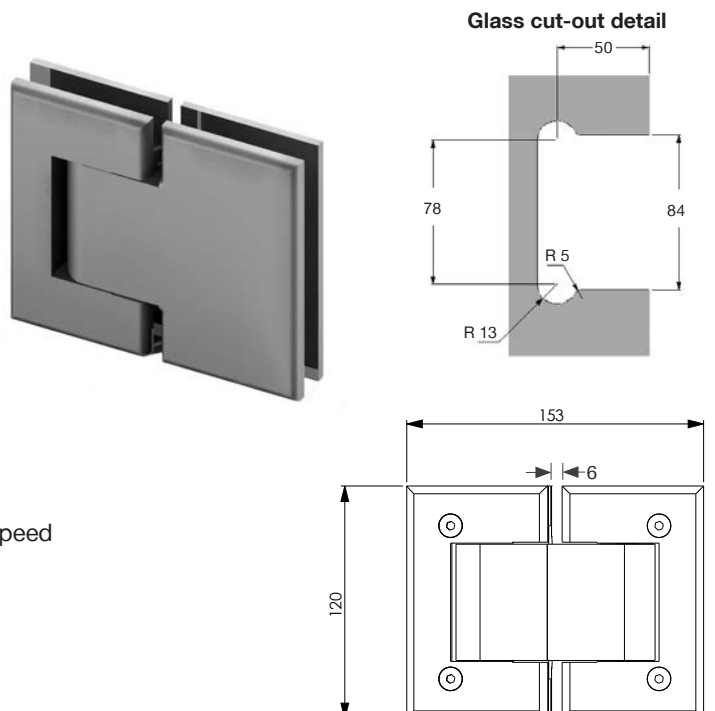

BALUSTRADE & POOL: VIENNA POOL GATE LATCHES

(Profile & finish to complement hydraulic hinge)

CALL: (09) 624-1180
www.euroglass.co.nz

euroglass™

EHPL1 Gate latch and strike

AVAILABLE FINISHES

- Polished stainless steel, marine grade 316

TECHNICAL DETAILS

Designed for a frameless glass pool gate that closes to a post or wall
Single action, self-latching magnetic operation
Manufactured in aluminium and stainless steel
Standard for 12mm glass, can be supplied for 10mm or 15mm glass on request

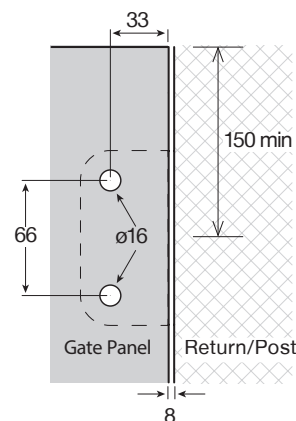
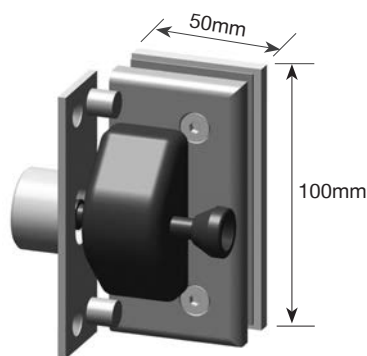

Glass Preparation

EHPL1RP Round Post Gate latch and strike

AVAILABLE FINISHES

- Polished stainless steel, marine grade 316

TECHNICAL DETAILS

Designed for a frameless glass pool gate 50mm dia. post mount
Single action, self-latching magnetic operation
Manufactured in aluminium and stainless steel
Standard for 12mm glass, can be supplied for 10mm or 15mm glass on request

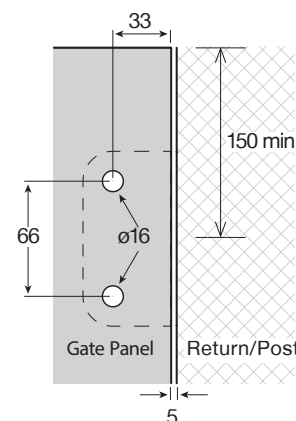
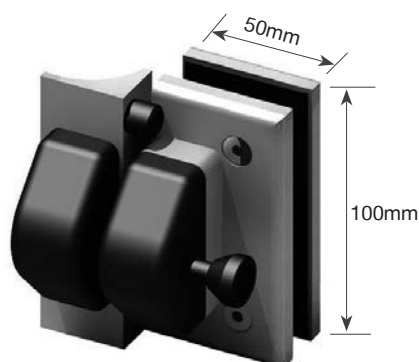

Glass Preparation

Made to order only

EHPL2 Gate latch and keeper

AVAILABLE FINISHES

- Polished stainless steel, marine grade 316

TECHNICAL DETAILS

Designed for a frameless glass pool gate and side panel
Single action, self-latching magnetic operation
Manufactured in aluminium and stainless steel
Standard for 12mm glass, can be supplied for 10mm or 15mm glass on request

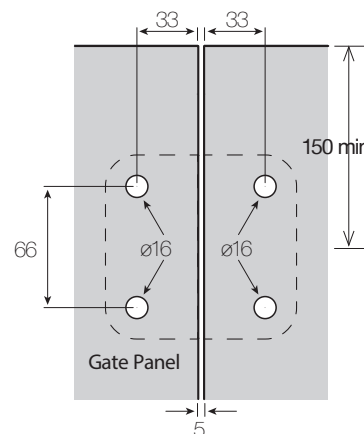
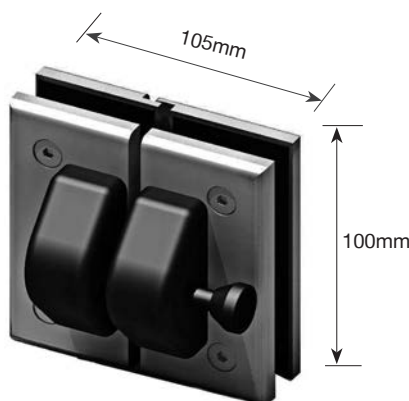

Glass Preparation

EHPL290 Gate latch and keeper

AVAILABLE FINISHES

- Polished stainless steel, marine grade 316

TECHNICAL DETAILS

Designed for a frameless glass pool gate that closes to a side panel at 90°
Single action, self-latching magnetic operation
Manufactured in aluminium and stainless steel
Standard for 12mm glass, can be supplied for 10mm or 15mm glass on request

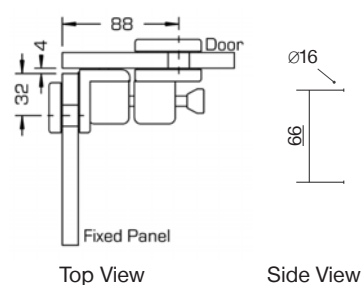
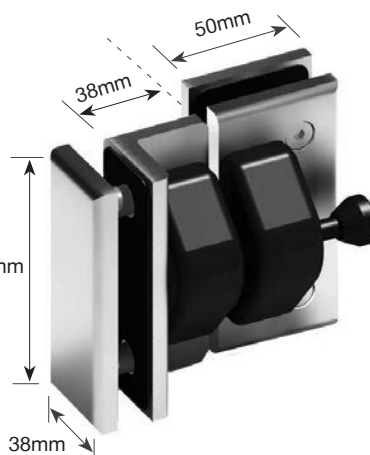

Glass Preparation

FPF790 Europool top pivot arm 90°

AVAILABLE FINISHES

- Polished stainless steel
- Satin stainless steel

TECHNICAL DETAILS

Designed for mounting a glass gate to a glass balustrade

Used in conjunction with HPT20/HPT10 top patch fittings that allows them to work as a top pivot set

Frameless glass mounting

Manufactured in 316 stainless steel

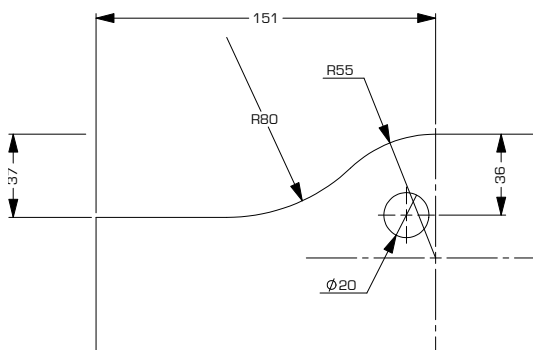
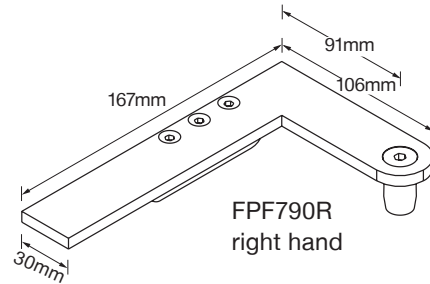
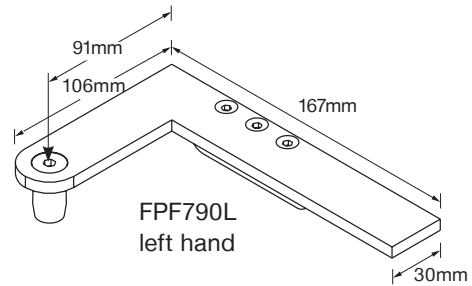
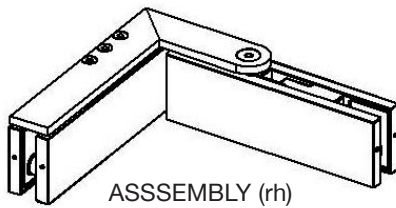

RETURN PANEL

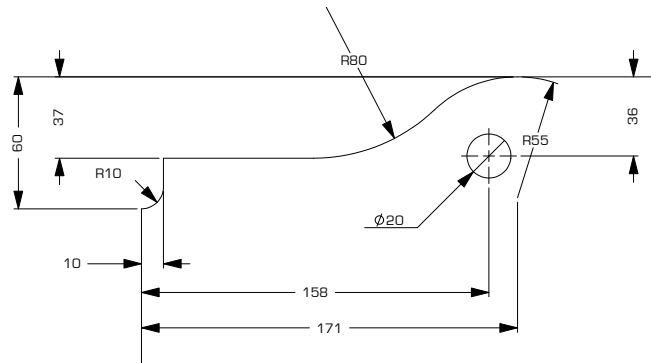

DOOR

HPT20PG Top fitting to suit pool gate pivots

AVAILABLE FINISHES

- Polished stainless steel
- Satin stainless steel

TECHNICAL DETAILS

Top patch fitting suitable for Euroglass pool gate fittings: FPF5/FPF6/FPF7 and FPF790/FPF8

Adjustable pivot insert

Features concealing cover plates

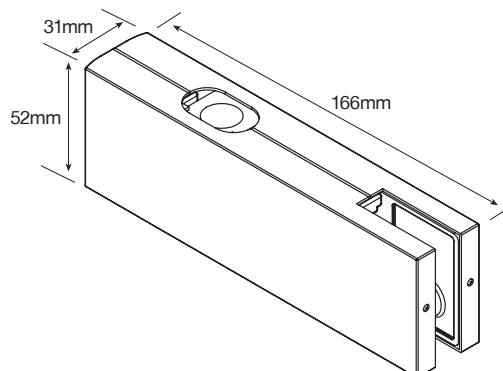
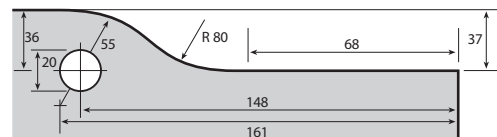

CABANA SLIDING BALUSTRADE BALCONY SCREEN

CABANA is the overall solution for balcony glazing.

The **CABANA** system is a practical solution for protection against wind and rain.

CABANA creates the perfect out door living environment on your balcony so you can enjoy the outdoors all year round.

FEATURES

A simple dual purpose system that provides protection from falling and shelter from the weather.

Quick and easy installation.

Cylinder push locks ensure additional protection.

Can be used with multiple sliding doors for wide openings.

Additional visual effects can be achieved by using Frosted, Coloured or DigiPrinted glass.

Small gaps between sliding glass panels can be filled with no obtrusive seals.

APPLICATIONS

- Out door living environments
- Residential & Commercial use
- For use on balconies that require shelter from the weather and protection from falling.

TECHNICAL DETAIL

Designed to take the following glass thicknesses;

- Balustrade infill panels; 12mm to 17.5mm
- Sliding door panels; 10mm to 13.5mm

Each sliding door can take a weight up to 100kgs

CABANA sliding door system and balustrade infill panels are attached to a floor mounted structural steel frame.

FINISHES

Natural satin anodised aluminium

Custom powder coat colour



CABANA SLIDING BALUSTRADE BALCONY SCREEN

Door Configuration

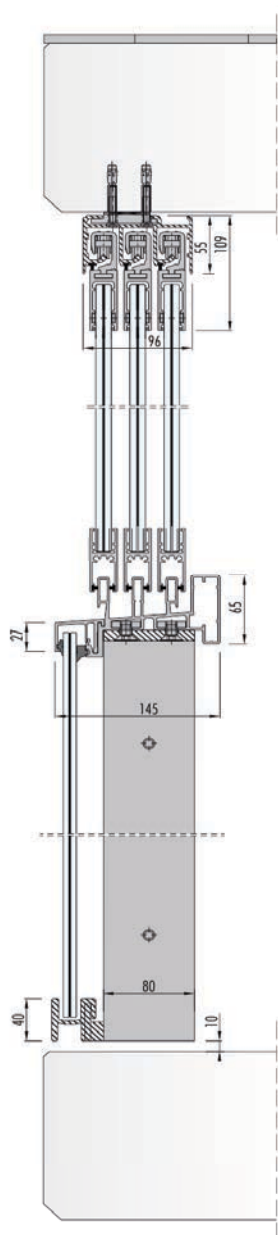

3 Doors Wide
Doors can be handed left or right

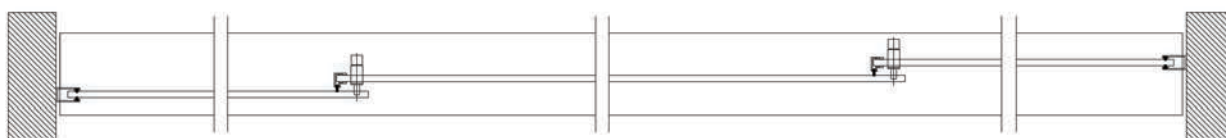

6 Doors Wide
Doors can be handed left or right

