

NOTES:

1. This proprietary balustrade system complies with New Zealand Building Code Clauses B1 Structure, B1/AS1 Amendment 15, B2 Durability, F2 Hazardous Building Materials and F4 Safety From Falling Third Edition, subject to:

-all products meeting their required performance specification

-site installation carried out in accordance with the intent of this drawing

2. Based on design loads from AS/NZS 1170.1 and a maximum uls wind pressure of 2.13 kPa (extra high wind zone), maximum span between posts and glass thicknesses are:

Commercial occupancies B , E & C3 of Table 3.3 AS/NZS 1170.1:

Based on 1100mm high balustrade, maximum span between posts -1650mm

Viridian safety glass options according to 22.4.3 of NZS 4223.3:2016 are:

- a. 10mm toughened glass with interlinking rail
- b. 11.2mm toughened laminated glass
- c. 11.52mm toughened SentryGlas laminated glass

-Interlinking rail must be connected to Milano posts, adjacent glass panes or to the building.

-Corner clamps shall be fixed on top of the glass panel.

3. The design of the concrete support is the responsibility of others.

4. A handrail of 32-50mm diameter is required for stairs and ramps exceeding 1:20 slope. Refer NZBC D1/AS1.

5. Use grade 316 stainless steel fixings and washers

6. Duratec powdercoat or 25 micron anodised finish is recommended for installations within 100m of the coast

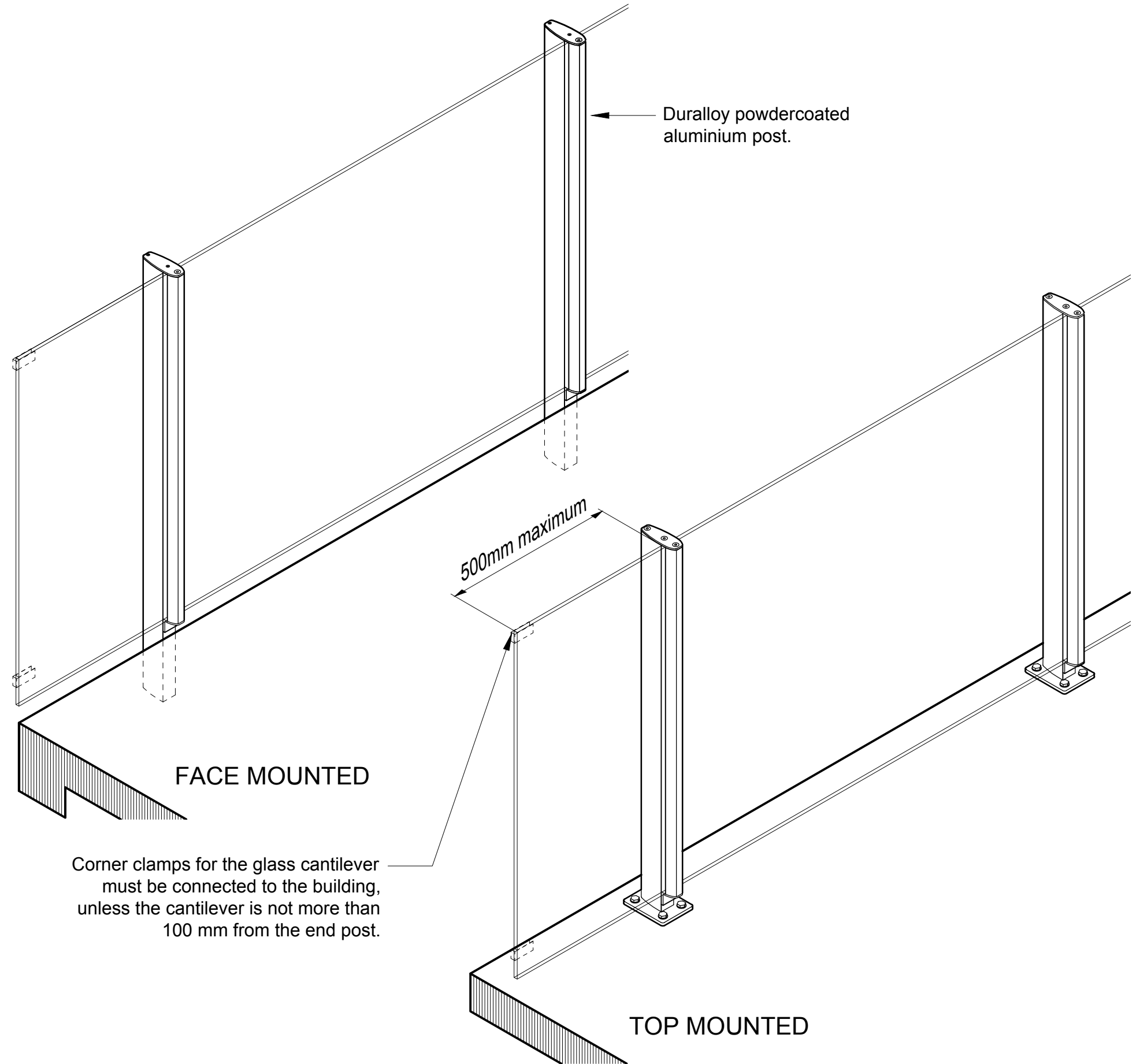

This post is protected by Design Registration # 413097 in New Zealand

Interlinking rail is required for 10mm toughened safety glass.

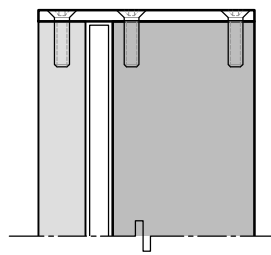

Ramset Epcon C6 or Hilti HY-200-R anchor with T316 s.s. threaded rod, 50x50x3 s.s washer, nylon bush and gasket to separate stainless steel and aluminum

M12 x T316 s.s dome nut, s.s. washer, s.s. spring washer, nylon bush and gasket to separate aluminium and stainless steel

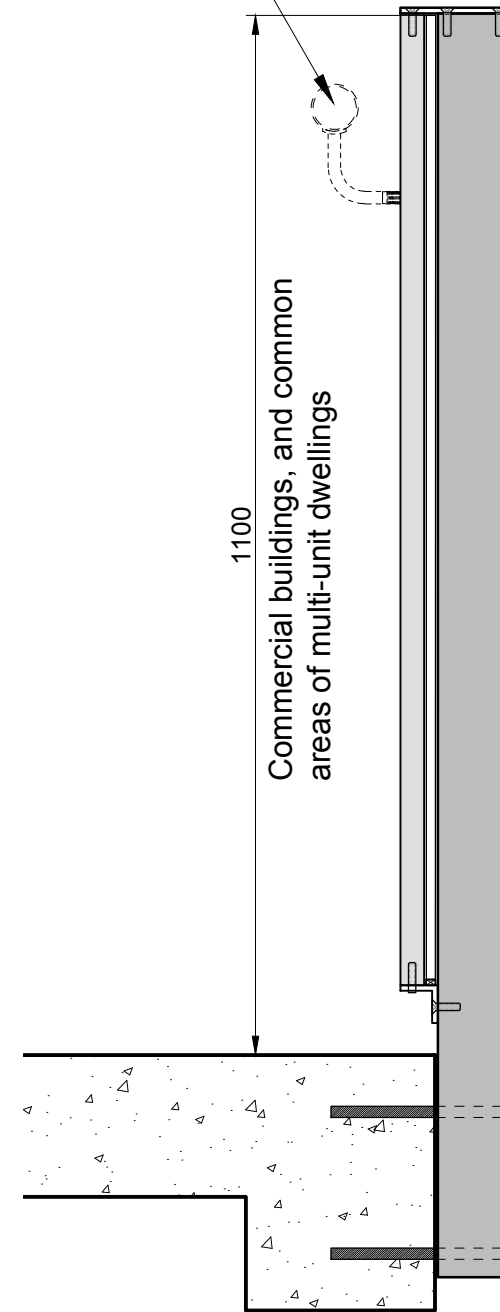
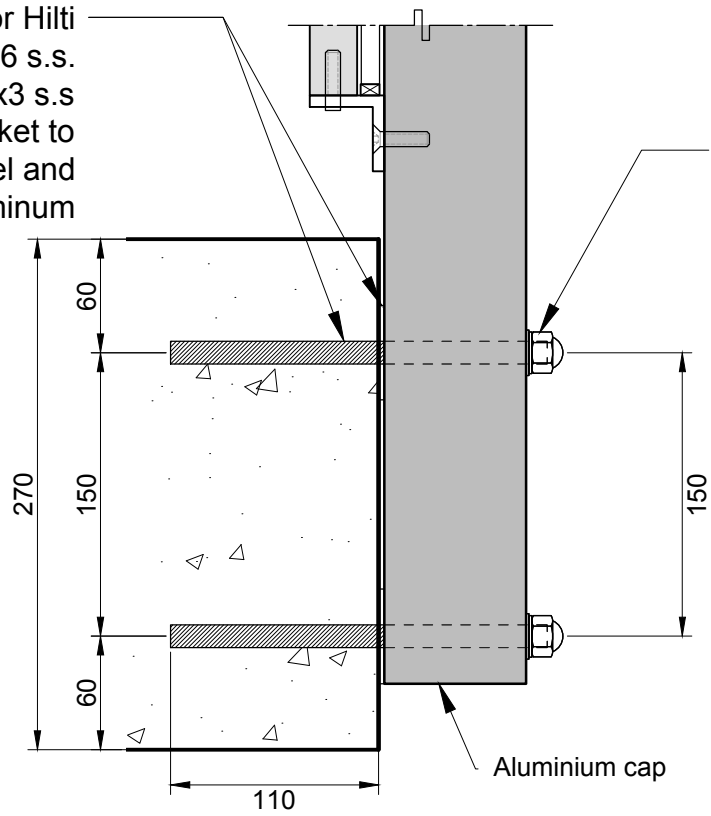

ECPFC post

Commercial buildings, and common areas of multi-unit dwellings

This post is protected by Design Registration # 413097 in New Zealand

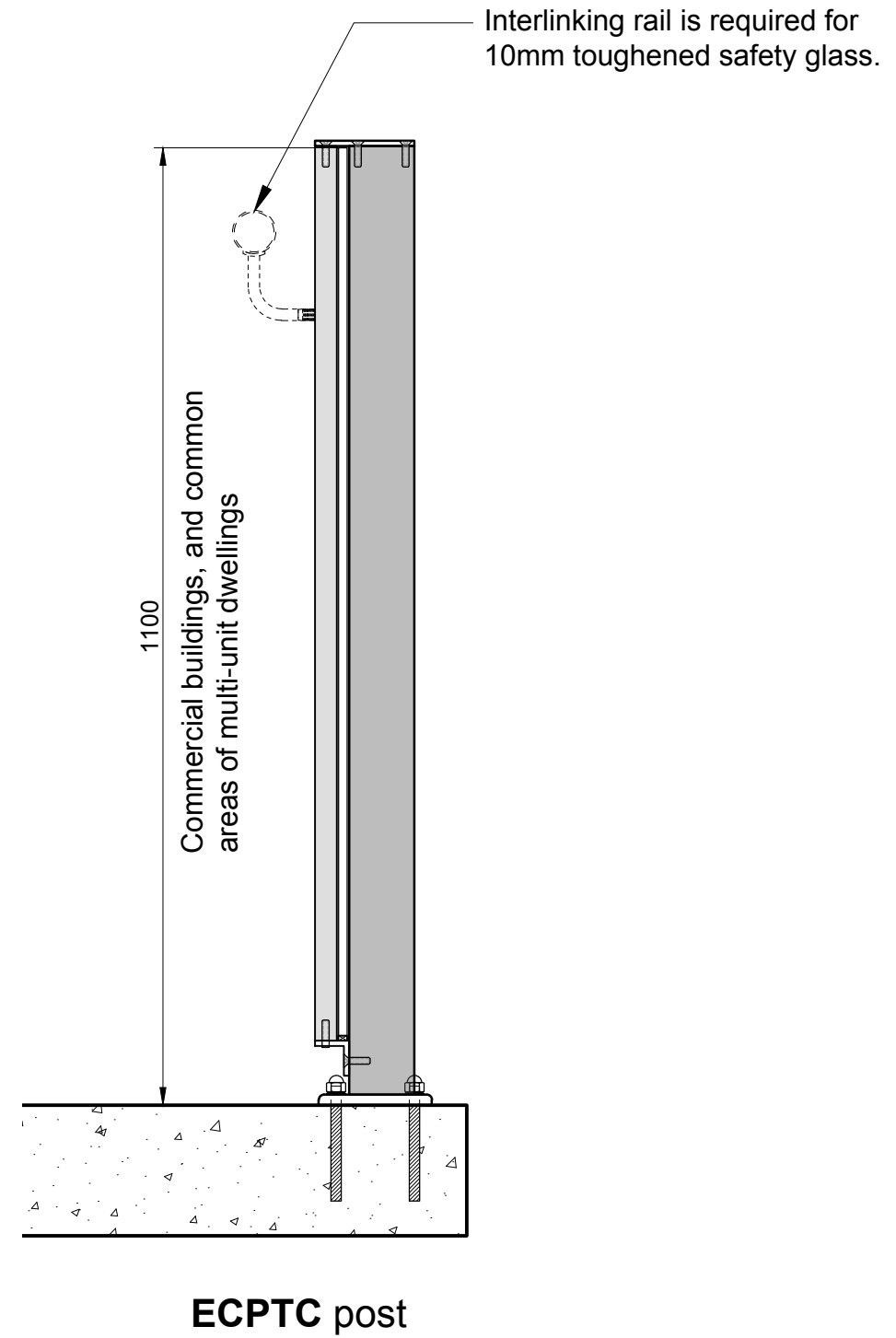
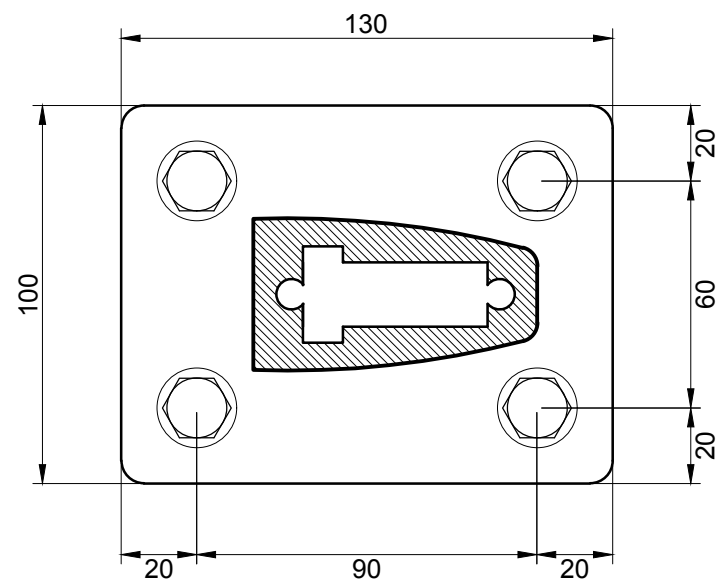
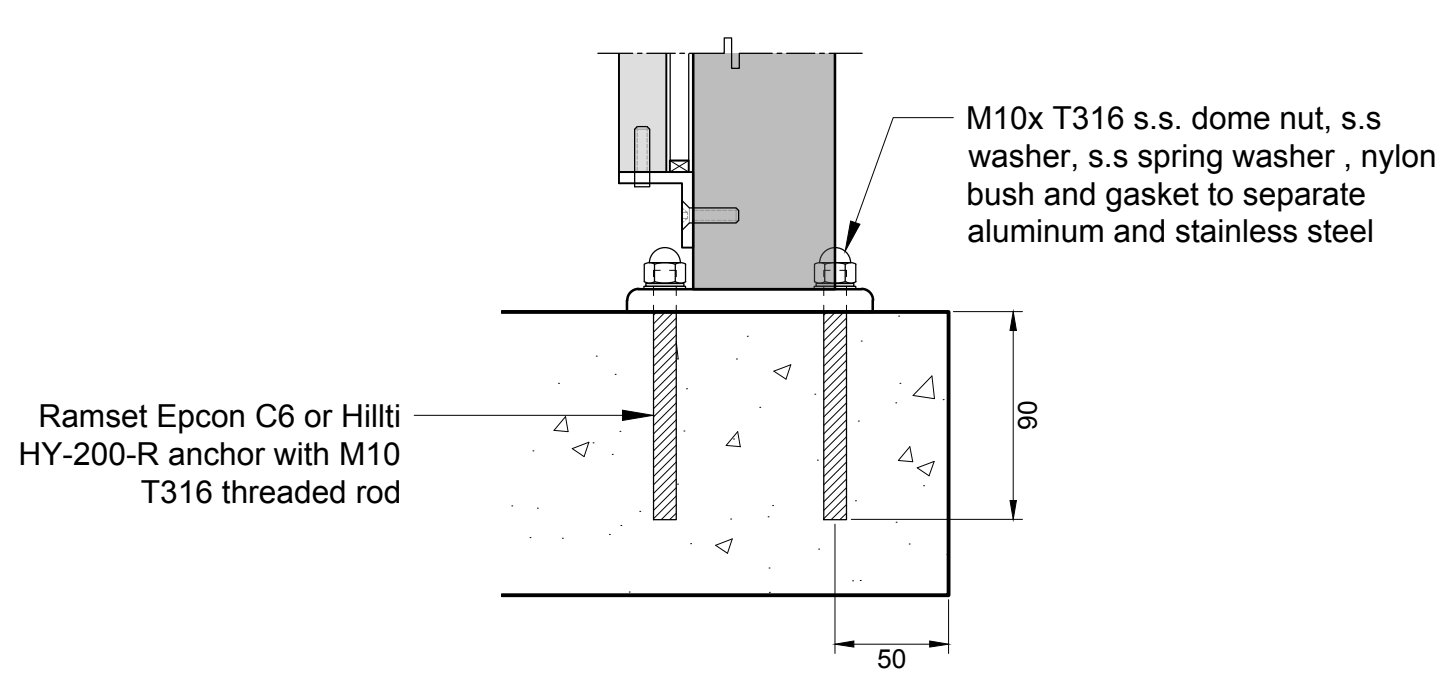

This post is protected by Design Registration # 413097 in New Zealand

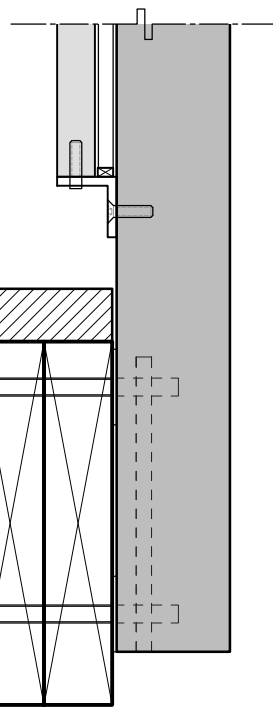
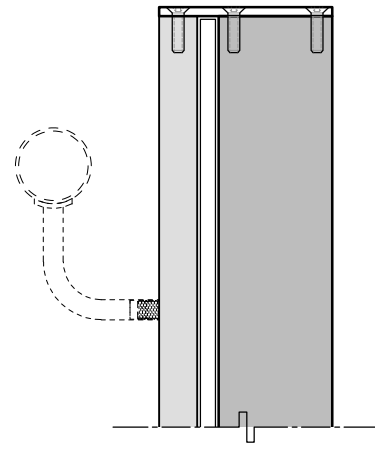

Steel or timber support.
Allow separation gasket and
nylon sleeves if external.

ECPHBT post
Concealed fixings
FIXING DETAIL A

Interlinking rail is required for
10mm toughened safety glass.

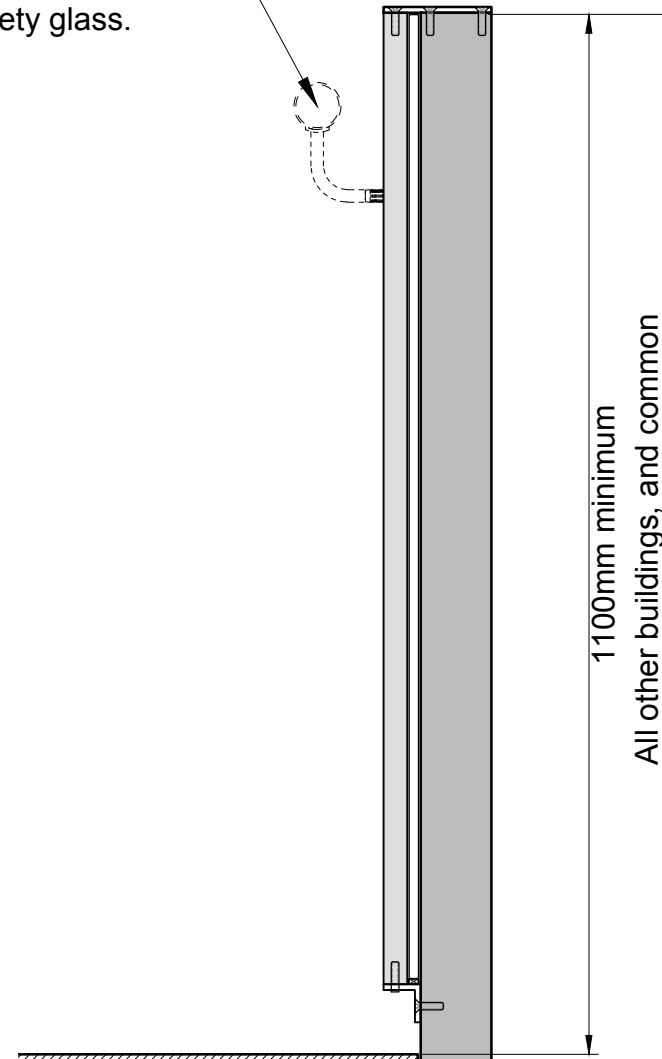

1100mm minimum
All other buildings, and common
areas of multi-unit dwellings

M12 x T316 bolt & 50x50x3
s.s. washer

M12 x T316 s.s dome nut, s.s.
washer, s.s. spring washer, nylon
bush and gasket to separate
aluminum and stainless steel

ECPFBT post
FIXING DETAIL B

This post is protected by Design Registration # 413097 in New Zealand

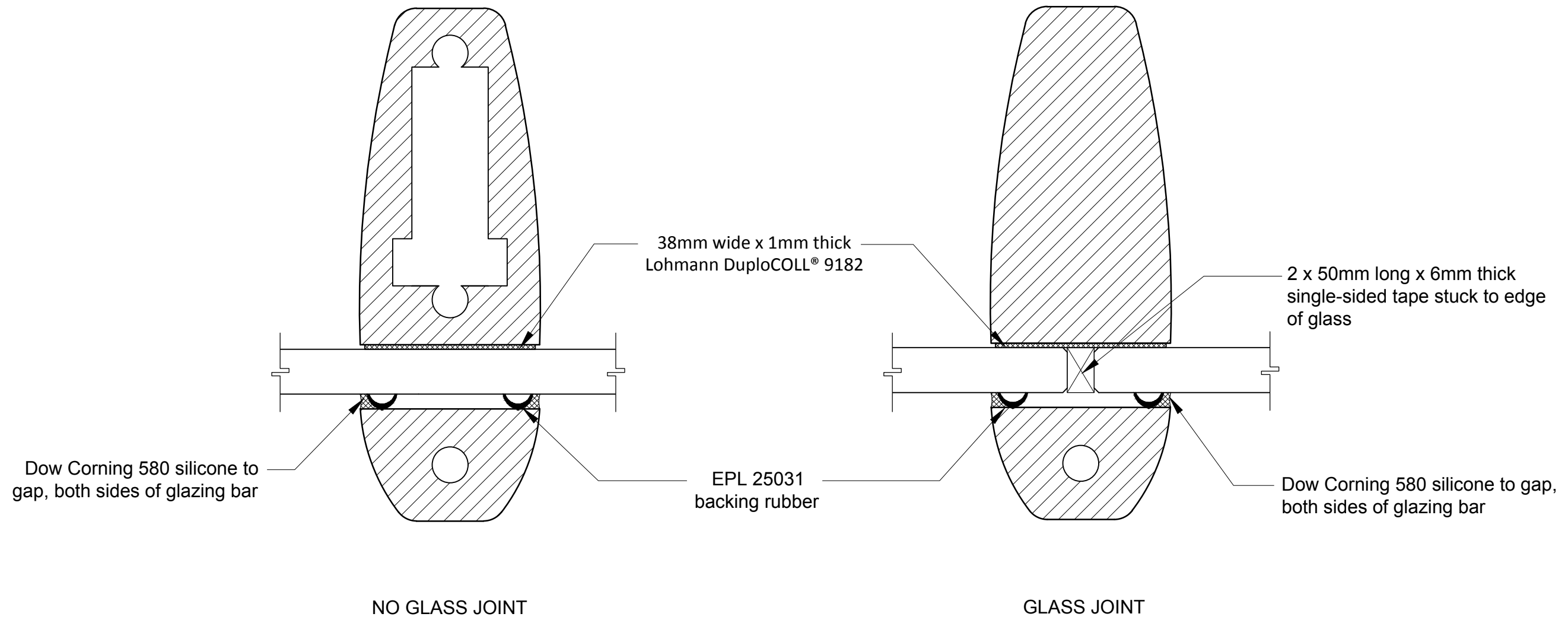

GLAZING DETAILS

This post is protected by Design Registration # 413097 in New Zealand